



**PRINCE EDWARD COUNTY
BOARD OF SUPERVISORS**

SUPERVISORS
BOARD MEETING

April 12, 2011
7:00 P.M.

A G E N D A

- 5:00 p.m. -- BUDGET WORK SESSION – Presentation of FY 12 School Budget**
- 7:00 p.m. 1. The Chairman will call the April meeting to order. 1**
- 2. Invocation 1**
- 3. PUBLIC PARTICIPATION: *Citizens wishing to address the Board are asked to please sign the Public Participation Register prior to the beginning of the meeting* 3**
- 4. Board of Supervisors Comments 5**
- 5. Consent Agenda:**
- a. Treasurer’s Report: December 2010 7**
January 2011 11
- b. Approval of Minutes: February 28, 2011 21**
March 15, 2011 23
March 17, 2011 26
March 29, 2011 @ 3:00 p.m. 32
March 29, 2011 @ 5:00 p.m. 40
April 5, 2011 44
- c. Review of Accounts & Claims 51**
- d. The County Administrator reported that checks have been issued pursuant to the order of the Board of Supervisors as to salaries, etc., the amount of which salaries have been heretofore approved. 71**
- e. Appropriations 73**
- f. Hampden-Sydney Chemistry Department Fireworks Display 75**
- 6. Highway Matters 77**
- 7:30 p.m. 7. PUBLIC HEARING – REQUEST FOR REZONING, RICHARD RAYMOND, JR. AND ROBERT RAYMOND, SR. – *The Board will receive citizen input prior to considering the request to rezone from A-2, Agricultural Residential, to C-1, General Commercial, a 1.5 acre parcel located at 4644 Farmville Road (U.S. 15 South), (Tax Map # 50-A-71).* 79**
- 8. Prince Edward County School Board Appointments: Announcement of Nominees 89**
- 9. Resolution: 75th Anniversary of Virginia State Parks 93**

10.	Citizen Volunteer Appointments: Authorize Advertising Vacancies	97
11.	<u>Planning and Community Development Report</u>	101
12.	<u>County Attorney's Report</u>	105
	a. Redistricting Update	
13.	<u>County Administrator's Report</u>	107
14.	<u>Committee Reports:</u>	117
	a. Personnel Committee	
	b. Monument Committee	
15.	<u>Correspondence:</u>	119
	a. Citizen E-mail, RE: Thank You to Planning Department	120
16.	<u>Monthly Reports:</u>	121
	a. Animal Control	122
	b. Building Official	123
	c. Cannery	125
	d. Prince Edward County Public Schools	126
	e. PERT	129
	f. Tourism	130

(NOTE: Additional agenda items may be added to the Table Pack, available for review after 4:30 p.m. on Tuesday, April 12, 2011.)



County of Prince Edward
Board of Supervisors
Agenda Summary

Meeting Date: April 12, 2011
Item No.: 1 & 2
Department: Board of Supervisors
Staff Contact: W.W. Bartlett
Issue: Call to Order and Invocation

Summary: Chairman William G. Fore, Jr. will call to order the **April** meeting of the Prince Edward Board of Supervisors and ask for an invocation.

Attachments: None.

Recommendation: None.

Motion _____
Second _____

Campbell _____
Jones _____
Wilck _____

Fore _____
McKay _____
Wiley _____

Gantt _____
Simpson _____



**County of Prince Edward
Board of Supervisors
Agenda Summary**

Meeting Date: April 12, 2011
Item No.: 3
Department: Board of Supervisors
Staff Contact:
Issue: Public Participation

Summary:

Public Participation is a time set aside for citizens to share their thoughts, ideas and concerns. An official record is made of each person's contribution tonight and will be directed to the County Administrator for follow-up; any necessary follow-up will be noted and tracked. Follow-up may consist of an immediate response, or planned action by the County Administrator or Board, or by placement on a future Board agenda. Tonight's agenda cannot be changed, because the public needs advance knowledge of and the opportunity to review related materials regarding items addressed by the Board. To further assist public information, the Board requests our Administrator, Attorney or county staff to immediately correct any factual error that might occur.

Attachments: Public Participation Tracking Form

Recommendation: None.

Motion _____
Second _____

Campbell _____
Jones _____
Wilck _____

Fore _____
McKay _____
Wiley _____

Gantt _____
Simpson _____

PUBLIC INPUT TRACKING LOG

ITEM NUMBER	CITIZEN REMARK	REMARK DATE	REPEAT REMARK	STATUS
1			Y N	
2				
3				
4				
5				
6				
7				
8				
9				
10				
11				
12				
13				
14				



County of Prince Edward
Board of Supervisors
Agenda Summary

Meeting Date: April 12, 2011
Item No.: 4
Department: Board of Supervisors
Staff Contact:
Issue: Board of Supervisors Comments

Summary: The Board has set aside ten minutes for Board members to respond to citizen input from Public Participation.

Attachments: None.

Recommendation: None.

Motion _____
Second _____

Campbell _____
Jones _____
Wilck _____

Fore _____
McKay _____
Wiley _____

Gantt _____
Simpson _____

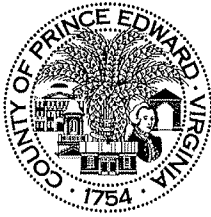

County of Prince Edward
Board of Supervisors
Agenda Summary

Meeting Date: April 12, 2011
Item No.: 5-a
Department: Treasurer
Staff Contact: Mable Shanaberger
Issue: Consent Agenda - Treasurer's Report

Summary: The December 2010 and January 2011 Treasurer's Reports are attached.

Attachments: December 2010 Treasurer's Report.
January 2011 Treasurer's Report.

Recommendation: Approval.

Motion _____
Second _____

Campbell _____
Jones _____
Wilck _____

Fore _____
McKay _____
Wiley _____

Gantt _____
Simpson _____

Prince Edward County Board of Supervisors

*Of this \$13,009,171.86 in the General Fund, \$5,848,090.91 is encumbered for:			
Transfers In:			
	School Fund		4,870,143.63
	VPA Fund		421,554.58
	Water Fund		0.00
	Sewer Fund		0.00
	IDA Fund		26,701.14
	Retirement Benefits Fd		6,696.00
	Debt Obligations		522,995.56
	Total		5,848,090.91
This leaves an unencumbered balance of \$7,161,080.95 in the General Fund.			

**Prince Edward Co. Board of Supervisors
Depository Balances**

Checking Accounts:

Benchmark Community Bank	\$	390,255.35
Wachovia Bank	\$	290,288.82
BB&T	\$	1,799,642.55
Bank of America	\$	1,775,456.89

Total: **\$ 4,255,643.61**

Investment Accounts:

Benchmark Community Bank	\$	11,645,484.06
Wachovia Bank	\$	112,128.73
Citizens Bank & Trust Company	\$	235,000.00
BB&T	\$	1,489.99
Planters Bank & Trust	\$	200,000.00
Mentor Investments	\$	162,394.62
SNAP (State Non-Arbitrage Plan)	\$	-
Bank of America	\$	-

Total: **\$ 12,356,497.40**

Mable H. Shanaberger, Treasurer

Prince Edward County Board of Supervisors

Description	Sub-Fund Balances	Fund Balances	Account Balances
General Fund	\$ 120,953.64		
General Fund Res. for Investments	\$ 11,742,676.38	\$ 11,863,630.02	*
PPEA Fund		\$ (1,529.57)	
Industrial Development Authority Fund		\$ 112,307.73	
Recreation Fund Res for Investments		\$ 26,934.36	
Forfeited Assets Fd. Res. for Inv.		\$ 91,040.04	
School Capital Projects Fund--VPSA		\$ -	
School Capital Projects Fund--QZAB01		\$ -	
Underground Storage Tank Fund		\$ 20,000.00	
Economic Development Fund		\$ 746,936.98	
Board of Public Welfare Special Acct.		\$ 8,542.20	
Piedmont ASAP Fund		\$ 282,352.45	
QZAB Debt Services Fund		\$ 408,068.97	
Landfill Construction Fund		\$ 766,928.50	
PCS Fund		\$ 288,316.68	
Revenue Sharing Fund		\$ 37,412.36	
Retirement Benefits Fund		\$ 2,642.00	
School Capital Projects Fund--QZAB02		\$ -	
Dare Donations Fund		\$ 964.06	
School Cafeteria Fund		\$ 266,657.24	
Pr Ed Community Dev Fund		\$ 46,793.50	
Water Fund		\$ 473,363.27	
Sewer Fund		\$ (29,077.41)	\$ -
School Fund		\$ -	
Cash in Office			\$ 1,000.00
Cash in Banks			\$ 1,524,381.66
Warrants Payable (School Fund)			\$ -
General Fund Investments			\$ 12,887,637.18
VPSA Investments			\$ -
QZAB01 Investments			\$ -
Underground Storage Tank Fund			\$ 20,000.00
Recreation Fund Investments			\$ 26,928.48
QZAB02 Investments			\$ -
Landfill Construction Fund for Investment			\$ 743,252.87
Forfeited Asset Fd for Investment			\$ 95,431.69
Industrial Dev Auth Fd for Inv			\$ 113,651.50
Totals:		\$ 15,412,283.38	\$ 15,412,283.38

Prince Edward County Board of Supervisors

*Of this \$11,863,630.02 in the General Fund, \$4,973,769.79 is encumbered for:			
Transfers In:			
	School Fund		4,268,942.74
	VPA Fund		362,446.72
	Water Fund		0.00
	Sewer Fund		0.00
	IDA Fund		26,701.14
	Retirement Benefits Fd		6,696.00
	Debt Obligations		308,983.19
	Total		4,973,769.79
This leaves an unencumbered balance of \$6,889,860.23 in the General Fund.			

**Prince Edward Co. Board of Supervisors
Depository Balances**

Checking Accounts:

Benchmark Community Bank	\$	122,066.52
Wachovia Bank	\$	77,044.07
BB&T	\$	1,793,467.99
Bank of America	\$	1,591,971.41

Total: **\$ 3,584,549.99**

Investment Accounts:

Benchmark Community Bank	\$	11,117,061.98
Wachovia Bank	\$	110,784.80
Citizens Bank & Trust Company	\$	235,000.00
BB&T	\$	1,490.15
Planters Bank & Trust	\$	200,000.00
Mentor Investments	\$	162,396.46
SNAP (State Non-Arbitrage Plan)	\$	-
Bank of America	\$	-

Total: **\$ 11,826,733.39**

Mable H. Shanaberger, Treasurer

Report Date: Jan. 2011

Prince Edward County Board of Supervisors

*Of this \$11,597,712.74 in the General Fund, \$4,432,816.81 is encumbered for:			
Transfers In:			
	School Fund		4,735,306.93
	VPA Fund		356,657.07
	Water Fund		-625,000.00
	Sewer Fund		-625,000.00
	IDA Fund		28,280.48
	Retirement Benefits Fd		32,628.00
	Debt Obligations		529,944.33
	Total		4,432,816.81
This leaves an unencumbered balance of \$7,164,895.93 in the General Fund.			

**Prince Edward Co. Board of Supervisors
Depository Balances**

Checking Accounts:

Benchmark Community Bank	\$	83,799.87
Wachovia Bank	\$	145,191.89
BB&T	\$	2,618,753.49
Bank of America	\$	280,347.22

Total: **\$ 3,128,092.47**

Investment Accounts:

Benchmark Community Bank	\$	930,169.63
Wachovia Bank	\$	-
Citizens Bank & Trust Company	\$	236,009.83
BB&T	\$	5,948,205.13
Planters Bank & Trust	\$	398,263.08
Mentor Investments	\$	162,346.74
SNAP (State Non-Arbitrage Plan)	\$	183.55
Bank of America	\$	3,274,932.82

Total: **\$ 10,950,110.78**

Mable H. Shanaberger, Treasurer

Prince Edward County Board of Supervisors

*Of this \$10,830,438.01 in the General Fund, \$3,646,811.98 is encumbered for:			
Transfers In:			
	School Fund		4,235,859.25
	VPA Fund		308,284.33
	Water Fund		-625,000.00
	Sewer Fund		-625,000.00
	IDA Fund		910.90
	Retirement Benefits Fd		32,628.00
	Debt Obligations		319,129.50
	Total		3,646,811.98
This leaves an unencumbered balance of \$7,183,626.03 in the General Fund.			

**Prince Edward Co. Board of Supervisors
Depository Balances**

Checking Accounts:

Benchmark Community Bank	\$	114,878.03
Wachovia Bank	\$	186,780.43
BB&T	\$	1,986,166.10
Bank of America	\$	299,848.86

Total: **\$ 2,587,673.42**

Investment Accounts:

Benchmark Community Bank	\$	930,169.63
Wachovia Bank	\$	-
Citizens Bank & Trust Company	\$	236,009.83
BB&T	\$	5,945,689.08
Planters Bank & Trust	\$	398,260.08
Mentor Investments	\$	162,371.91
SNAP (State Non-Arbitrage Plan)	\$	-
Bank of America	\$	3,272,515.77

Total: **\$ 10,945,016.30**

Mable H. Shanaberger, Treasurer

Report Date: January 2010



County of Prince Edward
Board of Supervisors
Agenda Summary

Meeting Date: April 12, 2011
Item No.: 5-b
Department: County Administration
Staff Contact: Karin Everhart
Issue: Consent Agenda - Approval of Minutes

Summary: Meeting minutes are attached for your review and approval.

Attachments: February 28, 2011
March 15, 2011
March 17, 2011
March 29, 2011 @ 3:00 p.m.
March 29, 2011 @ 5:00 p.m.
April 5, 2011

Recommendation: Approval.

Motion _____
Second _____

Campbell _____
Jones _____
Wilck _____

Fore _____
McKay _____
Wiley _____

Gantt _____
Simpson _____

February 28, 2011

At a special meeting of the Board of Supervisors of Prince Edward County, held in the banquet room of the Farmville Municipal Golf Course, 36 Wedgewood Drive, Farmville, Virginia, on Monday, the 28th day of February 2011; at 11:30 a.m., there were present:

William G. Fore, Jr.	Mayor Sydnor Newman, Jr.
Robert M. Jones	Dr. Edward I. Gordon
Howard M. Campbell	Donald L. Hunter
Charles W. McKay	Otto S. Overton
Howard F. Simpson	Thomas B. Pairet
Jim R. Wilck	Sally B. Thompson
Mattie P. Wiley	David E. Whitus
	A. D. "Chuckie" Reid

Absent: Don C. Gantt, Jr.

Also present: Wade Bartlett, County Administrator; Gerald J. Spates, Farmville Town Manager.

Chairman Fore and Mayor Newman called the governing bodies to order at 11:40 a.m. Council Member Mr. Whitus offered the prayer.

Mr. Bartlett provided an update on various County projects, followed by Mr. Spates speaking on several Town projects.

Council Member Thompson spoke suggesting the Town and County build a pipeline from Sandy River to Wilck's Lake and that both governing bodies operate the Town's water treatment plant together, sharing the expense and operational maintenance. She suggested a committee be formed.

Chairman Fore responded saying that the County needs additional information in order to make an educated decision and they are not ready to talk about the water at this time. Mr. Bartlett said the County is waiting on the financial analysis, prior to discussing their options. Members spoke briefly on the proposed water project; no action was taken.

On motion of Supervisor Simpson and adopted by the following vote:

Aye:	Howard M. Campbell	Nay: None
	William G. Fore, Jr.	
	Don C. Gantt	
	Robert M. Jones	
	Charles W. McKay	
	Howard F. Simpson	
	Jim R. Wilck	
	Mattie P. Wiley	

the meeting was adjourned at 12:45 p.m.

March 15, 2011

At a reconvened meeting of the Board of Supervisors of Prince Edward County, held jointly with the School Board of Prince Edward County, in the Prince Edward County Schools Career and Technical Center, Eagle Drive, Farmville, Virginia, on Tuesday, March 15, 2011 at 5:00 p.m., there were present:

Board of Supervisors

William G. Fore, Jr., Chairman
Howard F. Simpson, Vice Chairman
Howard M. Campbell
Don C. Gantt
Robert M. Jones
Charles W. McKay
Jim R. Wilck
Mattie P. Wiley

School Board

Russell L. Dove, Chairman
Susan S. Lawman
Linda L. Leatherwood
Lawrence C. Varner
Harriett Fentress
Ellery Sedgwick
Osa Sue Dowdy
Thomas M. Tillerson

Also present: Wade Bartlett, County Administrator; Sarah Elam Puckett, Assistant County Administrator; Stanley Jones, Division Superintendent; Dr. K. David Smith, Superintendent; and Cindy Wahrman, Division Director of Finance.

Chairman Dove called the School Board to order.

Chairman Fore called the Board of Supervisors to order at 5:00 p.m., as a reconvened meeting in order to meet with the Prince Edward County School Board to discuss the school budget.

Supervisor McKay offered the invocation.

Following dinner, Dr. Smith thanked the Board for its support and the level funding; Ms. Cindy Wahrman gave an overview of the budget proposed for FY 2011-2012.

Ms. Wahrman said state revenues are down \$615,485, and federal funding has a net increase of \$122,286. She stated Virginia Retirement System payments will increase \$310,340 and Health Insurance costs will rise \$56,800. Overall the school will have a FY12 funding reduction of \$860,339.

Actions required to absorb this reduction included:

- Not filling five unfilled positions saving \$253,820
- Eliminate four part-time and two full-time positions, saving \$140,360
- Eliminating one-time ARRA expenditures, saving \$350,655

These actions will save \$744,835. She reviewed additional reductions totaling \$487,250 and additional funding for \$70,500. Taken together those actions produced \$301,246 in funds that would be available in FY12.

Supervisor Wiley inquired about the cost of a 2% pay increase; Dr. Smith said the 2% increase in pay with the benefits attached would cost \$333,700. Discussion followed on the forecast for the 2012-2013 budget year.

Discussion followed on an article stating the school needed \$5-10 million for the athletic department; Supervisor Jones said the article referred to Dr. Smith meeting with the Planning Commission on the capital needs for the school. Dr. Smith said \$5 million was for the athletic complex; he added the critical needs are related to the roof repair or replacement and the HVAC replacement. He then discussed improvements made in the athletic complex to date.

Discussion followed on various ways to conserve energy and expenses.

Dr. Smith responded to a question regarding Cambridge; he said there has been a positive difference and they are providing targeted professional development, coaching and support. The representative is present almost full-time.

Dr. Smith said that the proposed budget allows the support that they need to make the improvements necessary while not allowing the extravagance to lose focus or lose sight of priorities on increasing student achievement and improving the programs offered to the children. He added that they are appreciative of the funding the Board is providing and the ability to have open dialog with the Board of Supervisors.

In Re: Adjournment

Chairman Fore thanked Chairman Dove, Dr. Smith and the members of the School Board for dinner.

Discussion followed on student attendance.

Supervisor Gantt made a motion that the County provides \$1,600 for four game systems for attendance prizes to be divided among the four buildings, with funding to be provided from the Recreation Fund. Following some discussion, the motion carried:

Aye: Howard M. Campbell
William G. Fore, Jr.
Don C. Gantt
Robert M. Jones
Charles W. McKay
Howard F. Simpson
Jim R. Wilck
Mattie P. Wiley

Nay: None

On motion of Supervisor Simpson and adopted by the following vote:

Aye: Howard M. Campbell
William G. Fore, Jr.
Don C. Gantt
Robert M. Jones
Charles W. McKay
Howard F. Simpson
Jim R. Wilck
Mattie P. Wiley

Nay: None

the meeting was recessed at 6:25 p.m. until Thursday, March 17, 2011 at 6:00 p.m.

March 17, 2011

At the regular meeting of the Board of Supervisors of Prince Edward County, held at the Court House, thereof, on Tuesday, the 17th day of March, 2011; at 6:00 p.m., there were present:

Howard M. Campbell

William G. Fore, Jr.

Don C. Gantt, Jr.

Robert M. Jones

Charles W. McKay

Howard F. Simpson

Jim R. Wilck

Mattie P. Wiley

Also present: Wade Bartlett, County Administrator; Sarah Elam Puckett, Assistant County Administrator; Jimmy Sanderson, Davenport & Company; Fred Pribble, Draper Aden Associates; Sheryl Stephens, Draper Aden Associates; Jeff Kapinos, Draper Aden Associates; Linnelle Stanhope, Crowder Construction.

Chairman Fore called the special meeting to order as a reconvened meeting from Tuesday, March 15, 2011. Supervisor McKay offered the invocation.

Chairman Fore read a prepared statement:

Tonight's meeting of the Prince Edward County Board of Supervisors is for the sole purpose of having a work session on the financing of the Sandy River Reservoir Water Project.

This is the second in a series of meetings that the Board will have with Crowder Construction and Draper Aden Associates now that scope of work of the PPEA Interim Agreement is nearing completion. We also have with us tonight, Jimmy Sanderson, from Davenport & Company, the County's financial advisor.

Davenport will be presenting an analysis of the County's current financial status and its ability to fund this project, based on the projected costs.

The Crowder/Draper Aden team will discuss with the Board the assumptions used to develop the operational budget of the proposed system, to include projected revenues and expenditures.

I would ask Board members to please limit your comments tonight to questions asking for clarification of the information presented. There is going to be a lot of information for us to absorb.

Let us all respect this process, so that we each have an opportunity to hear the information, think about it and ask appropriate and pertinent questions.

What I want the public to know is that tonight is not a public hearing or a public input session. Tonight is solely an informational briefing by Davenport, Crowder and Draper Aden for the Board of Supervisors.

The citizens of this county will have ample opportunity at a later date to ask questions and to have those questions answered. You will also have ample opportunity to give the Board of Supervisors input on the proposed project. I can assure the public that you will be given plenty of notice of when those opportunities are scheduled.

So, please use tonight to listen. Write down your questions and participate with us in this important opportunity to plan for Prince Edward County's future.

I thank each of you for your interest in the water project and for coming out tonight to learn more about it.

In Re: Presentation by County's Financial Advisor

Mr. Jimmy Sanderson, Davenport & Company, presented the Financial Analysis, including the County's current financial status, existing debt profile, peer group comparison to other localities in Virginia, historical revenues, fund balance trends, and capital modeling with respect to the Reservoir project. He reviewed Prince Edward County's rankings as compared with its peer group in the areas of population growth, governmental debt, debt service compared to revenues, and available financial resources. Mr. Sanderson said Prince Edward County has a healthy fund balance of just under \$10 million.

Mr. Sanderson then reviewed the current perspective on future debt capacity and impact the proposed Capital Improvement Project would make on the future debt capacity; the County currently has approximately \$15.5 million outstanding debt; the current debt service is approximately \$1.9 million and will drop off over the next few years. He said the County is in an extremely favorable financial position when compared to other Virginia governments. Mr. Sanderson stated that 72% of the County debt will be repaid over the next 10 years; this equates to about \$1.2 million. The County has the ability to finance the water plant project and maintain healthy financial ratios. Utilizing the County's decrease in existing debt service and projected system revenues, the County can establish a rate stabilization fund of approximately \$4 million and avoid any future tax increases associated with this project based on the stated assumptions. Utilizing a conservative 2.5% growth rate in the County Real Estate Tax Revenues, the County will have an additional \$1.3 million per year beginning in FY 2018 to supplement the General Fund. Mr. Sanderson then

presented Preliminary Funding case examples. Prince Edward's portion of the project is approximately \$19.6 million, making the debt associated with the existing line of credit permanent increases the amount to be financed to \$24,028,661. Mr. Bartlett stated the analysis assumes only revenues from the Real Estate tax would be used to pay this project. Real Estate taxes are about \$6 million and total local revenues are about \$15 million. He stated we are only talking about using a portion of 40% of all local revenues to fund the project and the other 60% would be available for other projects and expenses.

Supervisor Wilck questioned the current customer base. Mr. Sanderson stated when looking at a water project, assumptions must be made as to what expenses and revenues will be; additionally, assumptions had to be made as to what interest rates would be. Davenport used projected revenues that were provided by Draper Aden and factored those into the analysis. Discussion followed on building a customer base, current interest rates and the amount of debt service that would be incurred. It was stated short-term interest rates are about 2.0% and if funding were obtained in the near future, the cost from years 2013-2016 would decrease from \$901,000 to about \$500,000. This would be a savings of about \$1.6 million and would reduce the amount needed in the rate stabilization fund from \$4 million to \$2.4 million.

Supervisor Gantt asked if the numbers are based on Crewe and Burkeville; Mr. Bartlett said that if Crewe and Burkeville do not join the Authority or agree to be customers, the lines will not be extended to those areas, diminishing the costs, and may reduce the size of the plant. Mr. Bartlett added that approximately \$46,500 has been collected from existing customers in connection fees alone.

In Re: Presentation by Crowder Construction and Draper Aden Associates

Cheryl Stephens, Draper Aden Associates, presented a report on the proposed allocation of capital costs and debt service, projected water demands and projected cash flow for the Virginia Heartland Regional Water and Sewer Authority. Ms. Stephens reviewed the cost allocated to the project and the size of the treatment plant (2mgd); she said as the other localities request more capacity, their costs increase and Prince Edward County's cost decreases.

Ms. Stephens said the revenue projections for projected demands in Prince Edward County are conservative, estimating usage of approximately 80,000 gpd and increasing to about 120,000 per day over a ten year period; no assumptions for significant growth were included. The projections for connection fees

were kept low, although the connection fees can be significant, as in the case of Granite Falls which is approaching \$200,000 for water alone. She added that even at these low projections, revenue would be more than \$150,000 to start and increase to approximately \$224,000 in a ten year time frame. Ms. Stephens reviewed the projected usage of water, with the Authority selling approximately a half million gallons per day and assumed a two percent increase in sales over a ten year period, a very conservative estimate of growth. The water sales of approximately \$40,000 from Burkeville and \$440,000 from Crewe and from county customers would generate approximately \$600,000 in revenues. These revenues would provide funding to cover operating expenses and maintain the distribution system in the county.

Supervisor Wilck questioned why only six percent of the fees were being charged to Crewe and Burkeville. Ms. Stephens said Prince Edward County paying the higher 94% saves all future capacity of the reservoir for Prince Edward County. Mr. Fred Pribble, Draper Aden Associates, said the intake is an 8mgd intake and that the 480,000 gallons allocated to Crewe and Burkeville represents 6% of the capacity of the intake. Prince Edward County would then sell 6% to Crewe and Burkeville and Prince Edward County owns 94%.

Supervisor Wilck said a permit from the Department of Environmental Quality (DEQ) from December 7, 2006 which expires in 2021, grants permission to take 1.36 billion gallons per year; divided by 365 equals 3.7mgd. Mr. Pribble stated that is for an average day for that permit; the maximum daily is 6.3mgd, and the County could go back and request the maximum safe yield of the reservoir as the demand increases. Supervisor Wilck said the permit states only 1.7mgd can be used by the County and questioned the size of the 8mgd intake; Mr. Pribble stated you only want to go into the reservoir one time because of cost, and the safe yield of the reservoir is 8mgd. Discussion followed.

Supervisor Wilck then questioned the proposed allocation of 1.5 million gallons per day of the treatment plant to Prince Edward County; Ms. Stephens said the balance of the capacity of the 2mgd per day plant belongs to Prince Edward County to use or sell to someone else. The other localities of Crewe and Burkeville lump sum amount is their share of debt service; of the \$25 million, only \$19 million is Prince Edward County's share, the other \$5.5 million is debt service that will be paid for by the two communities for their share. Further discussion followed.

Jeff Kapinos, Draper Aden Associates, stated a smaller structure can be installed and a second could be installed at a later date, at a higher cost; the permit can be renewed as demand and yield increase up to the overall capacity. The 2mgd plant is what is assumed initially and that's why the percentages are based on 2mgd, which gives Prince Edward County the right to use that. He said the plant can operate for eight hours per day, not 24/7, saving operational costs. The capacity is then reserved for Prince Edward County.

After further discussion regarding the size of the plant, Supervisor Gantt suggested a 6mgd intake instead of an 8mgd intake. Mr. Bartlett stated the risk would be that the County would only have potential growth of 1-1.5 million and if there was a need to backfeed to the Town of Farmville for an emergency; another structure would add cost if it could be permitted. This plant is scalable to 4 million and could quickly go to 4 million capacity; he said the projections are looking at 30-40 years into the future.

Supervisor Gantt then suggested putting in the 8mgd intake which would not mean the County has to give anyone else anymore than the two [mgd]. If it is structured at 2mgd, it increases costs to Crewe and Burkeville. Mr. Bartlett stated that may make it too expensive to join the Authority. He added regionalization would provide the ability to seek grants; he said the allocation is of capacity, not usage.

Discussion followed on the water allocation from the Town of Farmville. Mr. Bartlett stated the Department of Health operation permit allows only 250,000 gallons per day.

Supervisor Wilck stated there are more than 40 million useable gallons of water in Wilcks Lake, 100 million useable gallons in Mottley Lake, and the Town of Farmville designed a water intake for Buffalo Creek, where there are six or more watershed lakes with an additional 300 million gallons, making a total of 440 million gallons available during a drought. Supervisor Gantt agreed the water is there; take into consideration the property owners will complain. Supervisor Wilck said Piedmont Soil and Water can open the gates. Discussion followed.

Supervisor Campbell questioned which locality supplies water to the Department of Corrections (DOC); Ms. Stephens said Crewe supplies their water. Supervisor Campbell stated the DOC has been hauling in water every summer from Powhatan to Nottoway.

Mr. Bartlett stated the Department of Mental Health will make a decision soon concerning expansion of their facility served by Crewe; they will reach capacity by October of 2011 and want to

expand the facility somewhere in the state by 300 beds, and one restriction for the Crewe site is the amount of water available. He said the Department of Mental Health reported at least 20% of all employees live in Prince Edward County; 166 Prince Edward County residents work in the facility.

Discussion followed on the availability of regional grants which would significantly reduce costs.

Mr. Bartlett stated a letter of support has been received from Crewe, and Burkeville has given its mayor the authority to sign a similar letter.

On motion of Supervisor Simpson and adopted by the following vote:

Aye:	Howard M. Campbell	Nay: None
	William G. Fore, Jr.	
	Don C. Gantt	
	Robert M. Jones	
	Charles W. McKay	
	Howard F. Simpson	
	Jim R. Wilck	
	Mattie P. Wiley	

the meeting was adjourned at 8:05 p.m.

March 29, 2011

At a called meeting of the Board of Supervisors of Prince Edward County, held at the Court House, thereof, on Tuesday, the 29th day of March, 2011; at 3:00 p.m., there were present:

Howard M. Campbell

William G. Fore, Jr.

Don C. Gantt, Jr.

Robert M. Jones

Charles W. McKay

Howard F. Simpson

Jim R. Wilck

Mattie P. Wiley

Also present: Wade Bartlett, County Administrator; and Sarah Puckett, Assistant County Administrator.

Chairman Fore called the Special Meeting to order at 3:00 p.m. for a budget work session.

Chairman Fore presented Judge Richard S. Blanton with a Resolution of Respect on the event of Judge Blanton's retirement.

**BOARD OF SUPERVISORS OF THE COUNTY OF PRINCE EDWARD, VIRGINIA
~A RESOLUTION OF RESPECT~**

**The Honorable Richard S. Blanton
Circuit Court Judge, 10th Judicial District**

WHEREAS, the Honorable Richard S. Blanton, a native of Cumberland County and an esteemed judge of the 10th Judicial Circuit Court of Virginia, will retire March 31, 2011, after 16 years of distinguished service to the citizens of Prince Edward County and the 10th Judicial Circuit; and

WHEREAS, the Honorable Richard S. Blanton served his country in the United States Air Force from 1970 to 1974, received his undergraduate degree from Longwood College and was awarded his law degree from the Marshall-Wythe School of Law of the College of William and Mary; and

WHEREAS, from 1984 to 1989, the Honorable Richard S. Blanton held the elective office of Commonwealth's Attorney for the County of Cumberland, Virginia; and

WHEREAS, from 1984 to 1989, the Honorable Richard S. Blanton held the appointed office of County Attorney for the County of Cumberland, Virginia; and

WHEREAS, from 1989 to 1995, the Honorable Richard S. Blanton held the appointed office of County Attorney for the County of Prince Edward, Virginia; and

WHEREAS, in 1995, the Honorable Richard S. Blanton was elected by the Virginia General Assembly to be a Circuit Court Judge in the 10th Judicial Circuit and was sworn in on April 1, 1995; and

WHEREAS, an admired jurist, the Honorable Richard S. Blanton has served two terms as a Circuit Court Judge and served as Chief Judge for the 10th Judicial Circuit for 2009 and 2010; and

WHEREAS, during his tenure as Circuit Court Judge, the Honorable Richard S. Blanton has heard a variety of cases, presiding with great decorum, honor, and commitment to equal justice for all; now

THEREFORE, BE IT RESOLVED, that the Board of Supervisors of the County of Prince Edward, Virginia does hereby convey its high regard to a singularly dedicated, distinguished and accomplished Virginian, the Honorable Richard S. Blanton; and, be it

RESOLVED, FURTHER, that a copy of this resolution be prepared for presentation to the Honorable Richard S. Blanton, as an expression of great respect and appreciation for his many years of public service, by the members of the Board of Supervisors of the County of Prince Edward, Virginia.

In Re: Tri-Boro Rack Site Plan Approval

Mr. Wade Bartlett, County Administrator, stated a Preliminary Site Plan has been submitted by Tri-Boro Shelving, Inc. for a business expansion, “Tri-Boro Rack” on Lot B, in the Prince Edward Business Park, and adjacent to the property presently occupied by Tri-Boro Shelving. There was also a Property Division Plat submitted, identifying the existing Tri-Boro Shelving as Lot A and the expansion as Lot B. The plans show a 62,500 square foot building with a future addition of 37,500 square feet. The Planning Commission has reviewed the site plans for compliance with the “Protective Covenants, Conditions, and Restrictions for the Prince Edward County Industrial Park.”

The Planning Commission, at their March 15, 2011 meeting, unanimously favored a motion which agreed that the 62,500 square foot building is within the context of the existing covenants provided that the following revision are addressed in the final plan so that the site plan will comply with the covenants:

- there is parking identified for Lot B consistent with Zoning requirements
- the area identified as “Storage and Laydown Area” not encroach within the 50’ setback

- any earthwork on the site not encroach in the right of way for Commerce Road
- that the landscaping covenant be applied to both Lot A and Lot B since the construction of the access to Lot B would have an impact on Lot A
- and the landscaping could be used as screening for the storage area

Following the Planning Commission recommendations, a revised site plan was submitted. This revised site plan has met the above recommendations, except for identifying parking and establishing landscaping plans. Landscaping and Screening are explained in Covenants A.4 and G.1. Parking is required in Covenant C.2.

The Prince Edward County Zoning Ordinance requires parking for Industrial Manufacturing and Warehousing uses. The Manufacturing use requires one (1) parking space per 1,000 square feet of manufacturing space. The Warehouse use requires one (1) parking space per 5,000 square feet of warehouse space. If the 62,500 square foot building was used equally for manufacturing and warehousing, the required parking would be 37 spaces. The owner has indicated 25 employees for this business site.

Mr. Bartlett indicated he spoke with the owner, who will provide parking spaces and will place a buffer of vegetative material between his and other parcels.

After further discussion, Supervisor Simpson made a motion to authorize the Zoning Administrator to approve the site plan contingent upon the recommendations of the Planning Commission, prior to obtaining a building permit; the motion carried:

Aye:	Howard M. Campbell William G. Fore, Jr. Don C. Gantt Robert M. Jones Charles W. McKay Howard F. Simpson Jim R. Wilck Mattie P. Wiley	Nay: None
------	---	-----------

In Re: Presentation of the County Administrator’s Budget

Mr. Bartlett reviewed his letter to the Board of Supervisors, as follows:

“I am pleased to present to the Board of Supervisors my recommended budget for Prince Edward County for Fiscal Year 2012 (FY12). I am glad to report I am presenting a balanced budget with no tax increases. I look forward to the Board’s feedback and response to the many difficult decisions that will be required during this year’s budgetary process. While this year was difficult, it was not as

challenging as the past few years. The reason for that was twofold: first, local revenues have stabilized and, in fact, have increased in some areas; and second, while the General Assembly continues the pattern of reducing funding to local governments and pushing the expenses of the state to local governments, the amount has slowed this year. With the current climate in Richmond, I do not foresee any will on the part of the General Assembly to provide additional revenue to local governments, even when the economy turns around. This does not bode well for local governments and will continue to place great pressure on us in the future.

For FY12 health insurance rates increased 3.9 %, which will cost the County approximately \$20,000. Because it is the second year of the biennium, there are no increases in the VRS or Group Life insurance rates. The General Assembly did pass one significant expense to local governments this year – Line of Duty Benefit. This is a benefit the General Assembly created for public safety employees, to include volunteers. The state has funded this benefit for many years. But now that the costs have increased the Commonwealth is forcing local governments to pick-up the tab. For Prince Edward County it will cost approximately \$26,000. This benefit provides a life insurance payment of \$100,000 which is in addition to any VRS insurance payments. But the main expense and the reason the costs have increased so rapidly is that the benefit provides free health insurance coverage for life for any spouse and insurance for any dependents until they reach the age of 25, if a full-time student.

Before discussing the new budget which starts on July 1, 2011, I think it is appropriate to review the current budget and the forecast of the state of the County's finance's at the start of the new fiscal year. Enclosure (1) is a chart of projected fund balances for each of our budgetary funds at the end of the current fiscal year. The General Fund is our primary source of revenue and supports the majority of all County operations. I project the General Fund will end FY11 with an increase in the fund balance of \$632,623. This will be the result of revenues exceeding forecasts by almost \$81,000 and expenses being less than the budgeted amounts by almost \$552,000. Besides the reimbursement of slightly more than \$183,000 from the bonds issued for the new Library, I do not foresee the revenues in any particular category either exceeding or falling short of the budget by a significant amount. Overall, General Property taxes, which is comprised of real estate, personal property, public service corporations, mobile homes, machinery & tools, merchant's capital and the penalty and interest charges associated with those taxes, will see collections of almost \$231,000 greater than their combined budgetary amounts.

Almost every department in the County has under expended its budget. I want to commend all County employees and Constitutional Officers and their employees for the hard work necessary to achieve such a positive outcome. This fund balance increase will play an important role in the FY12 budget as explained below.

Another major revenue source is the Landfill Construction Fund. Revenues from customers of the landfill located outside Prince Edward County are placed in this fund and are accumulated and are then used to pay for the closure and construction of new landfill cells. It is anticipated we will need to close a cell in the spring of 2012 and that cost is reflected in the FY12 budget for this fund.

For FY12, the Board of Supervisors made it clear they did not want to see any tax increases, and at the same time the Board wishes to maintain the current level of services to our citizens. This proposed budget meets those goals. I am proposing a budget that is relatively flat with only a few exceptions. After deducting the transfers between funds, the proposed budget for all funds is \$47,983,493. The budget is balanced but requires the use of some of the fund balances. I recommend using \$386,174 of the \$632,623 increase in the Fund Balance of the General Fund mentioned above and \$524,000 of the

fund balance of the Landfill Construction Fund. As mentioned earlier, the use of the Landfill Construction Fund reserves is the County's normal method of operation for capital costs associated with opening and closing cells at the Landfill.

The proposed budget includes the transfer of \$7,880,132 to the schools and represents level funding after deducting \$32,912 for the decrease in the debt service payments. Enclosure (2) is a chart that shows the revenues, expenses and projected fund balances of the various funds at the end of FY12. Enclosure (3) provides a comparison of the departmental costs over the last 3 years.

Factors shaping the FY12 Proposed Budget

The FY12 proposed budget incorporates the Board's direction to present a budget that level funds the schools, little if any use of the fund balance, no increase in tax rates, and at the same time maintain core service levels.

The FY12 proposed budget process comes amid a slowly improving economy. One statistic which conveys the economic health of a locality is the unemployment rate. Unemployment in Prince Edward County fell to 9.3% in January 2011, compared with 10.2% last January. This compares favorably to the unemployment rate for the nation which is 9.8% but is higher than the state average of 6.9% for the same period. The Commonwealth's overall rate also decreased almost a full percentage point the past year.

This improving economy, even if it is a slow recovery, bodes well for the future. We are seeing an increase in the number of business prospects displaying an interest in Prince Edward County. The future looks more promising now than it has for three years. Luck Stone is still proceeding on the opening of the quarry, we have two local businesses that are set to expand, and we are in serious negotiations with a firm that would be new to the area. Finally, I am hopeful the Granite Falls project will develop. While I am bullish on the future prospects of Prince Edward County, I did not factor any revenue growth from any of these projects into my revenue calculations.

The NADA values we have seen are showing a decrease of about 10% for used vehicles. The sale of new cars, which seem to be holding steady, will help offset this decline. But to be conservative I lowered the FY12 budgeted amount in this category by \$288,707 or almost 10% as compared to the amount in FY11. I do not foresee any other revenue source changing to such a degree.

Because of the uncertainty of the final decision involving the Sandy River Water Project both the Water and Sewer funds will be in a state of flux until a decision is made. I developed the budget for both funds with the assumption that the water project will not be funded. But the current Line of Credit matures in November and the temporary borrowing must be made permanent. I developed the Water and Sewer budgets with the assumption that the full line of credit would be draw down and the County would borrow \$4,700,000 payable over 10 years with an interest rate of 3.75% to retire the line of credit. To present the worst case scenario I assumed payments on the permanent financing would begin on July 1, 2011.

There are a number of outside factors that may still impact the FY12 budget. Final decisions and implementing instructions regarding the Commonwealth's budget have not been received. Thus, there is still uncertainty regarding the final disposition of State and Federal funding at the local level, but we must proceed with the information we have at hand. Enclosure (2) contains the projected fund balances at the end of FY 12.

FY12 Reduction Strategies

The Board of Supervisors has expressed its concern for the citizens who are struggling during this period of economic uncertainty. To meet the challenge laid out by the Board of Supervisors requires the help and sacrifice of the Constitutional Officers.

In addition to eliminating most capital purchases, the budget includes no pay increases for county employees. This will be the fourth year with no pay increases. But I am recommending a bonus be paid equal to 3% of employee's salary which will cost \$113,000.

The Prince Edward County School Board has requested \$8,155,132 in local funds for operations, which represents an increase of \$275,000 after accounting for the decrease in debt service. These funds would allow a pay raise of 1.5% for school employees. It is the schools intention to provide another \$275,000 and provide a pay raise of 3% for school employees. I recognize the education of our children is one of the cornerstones in fostering future prosperity for the County, but I am also very aware of the burdens our tax payers are facing. Faced with that choice and the fact the schools can afford to provide either a pay raise of 1.5% or a bonus with level funding I am not recommending increasing the funds provided to the Schools. I have fulfilled your desires and am recommending level funding for the Schools.

With revenues forecast to show no significant growth and expenses such as health insurance and state mandates increasing, it was very difficult to fund needed capital expenditures without a tax increase. To resolve that issue I am recommending the use of \$386,174 of the \$632,623 projected increase in the General Fund at the end of FY11. The expenses associated with this recommendation are one-time expenses that will not continue in the out years. It is appropriate to use one-time savings to pay for one-time expenses.

As stated above, capital expenditures are being kept to a minimum. The General Fund contains only five recommended capital projects totaling \$140,000. The first is an upgrade to the financial software system run on the AS400. This software will allow the County to place tax information on-line and allow citizens to make tax payments on the internet. This will cost \$14,000 for the software, and \$4,000 for the hardware for a total of \$18,000. I am recommending we replace the vehicle used by the Biosolids employee at a cost of \$22,000. It is anticipated that cost will be shared with the other Counties participating in this program. I am recommending a budget line of \$30,000 be approved for physical plant needs. There are no specific projects planned at this time but budgeting funds would allow me to respond to emergencies in a timely manner. The fourth item is \$15,000 for the replacement of various computers, printers and software. Finally, I am recommending the purchase of two cars for the sheriff at a cost of \$55,000.

In addition to capital purchases I recommend the use of \$18,500 to purchase non-capital equipment for the Sheriff, \$18,000 to allow the purchase of additional time from our information technology contractor and the \$113,000 for the bonus mentioned above. All of the items mention total \$289,500. The final item I am recommending to fund from the increase in the fund balance is the last payment of \$66,667 owed to the Town of Farmville on the Parking Lease. All of the items mentioned to include the capital projects total \$356,167.

Tax Rates

I recommend all tax rates be maintained at their current rates.

Water & Sewer

As stated above these funds are in a state of flux. I developed the budget of both funds with the assumption that the water project will not be funded. But the current Line of Credit matures in November and the temporary borrowing must be made permanent. I developed the Water and Sewer budgets with the assumption that the full line of credit would be draw down and the County would borrow \$4,700,000 payable over 10 years with an interest rate of 3.75% to retire the line of credit. To present the worst case scenario I assumed payments on the permanent financing would begin on July 1, 2011. A later starting date on repayment of the permanent financing could be arranged as explained by Mr. Sanderson in his presentation which would lessen the impact on County finances in FY12.

This requires a total payment of interest and principal of \$564,348 annually. The Water Fund would be charged with 72.2% of the payment and sewer with 27.8%. Making this debt permanent would allow the Water Fund the ability to repay the \$811,000 fronted by the General Fund in FY10. But such action would only be temporary since the Water and Sewer Funds currently do not generate enough revenue to fund such large debt payments. Therefore I am recommending the Water Fund be allowed to keep that money and use it to pay the debt service for FY12.

Conclusion

I look forward to our future work sessions and realize the Board may recommend changes to the proposed budget. That is understandable and expected. Thank you for this opportunity to present a balanced budget for the citizens of Prince Edward County.”

Mr. Bartlett asked the Board to contact him with any questions, and stated the next meeting would be regarding the donation requests. He recommended the Board not fund new requests; the Youth Empowerment Center is asking for \$30,000 and the Mary E. Branch Community Center is requesting \$23,750 but he does not recommend funding the Center due to the status of the licensing.

Supervisor Wiley asked for clarification on funding for the Water project; Mr. Bartlett said the budget does not include funds for the water project. He said if the Board proceeds with the project, changes will be necessary, but no debt will be incurred in FY12.

Supervisor McKay asked if all donations are recommended at level-funding. Mr. Bartlett said all are recommended at level funding except the Community Center. He said the Library is also recommended to be level funded at the cumulative amount provided in the previous year, for the Library to fund hours of operation.

Supervisor Wiley asked if the Board decides to move forward with the water project, would the County still be in a position to maintain the current tax rates. Mr. Bartlett said that as shown by the financing report by Davenport, the County would not see expenses in FY12 and interest only in FY13. Discussion followed.

Chairman Fore called a 40-minute recess at 4:16 p.m.

DRAFT

March 29, 2011

At a called meeting of the Board of Supervisors of Prince Edward County, held at the Court House, thereof, on Tuesday, the 29th day of March, 2011; at 5:00 p.m., there were present:

Howard M. Campbell

William G. Fore, Jr.

Don C. Gantt, Jr.

Robert M. Jones

Charles W. McKay

Howard F. Simpson

Jim R. Wilck

Mattie P. Wiley

Also present: Wade Bartlett, County Administrator; Sarah Puckett, Assistant County Administrator; Sharon Lee Carney, Director of Economic Development; and Andre Gilliam, Community Development Planner, Commonwealth Regional Council.

Chairman Fore called the Special Meeting back to order at 5:00 p.m. to hold the Public Hearing on the CDBG.

In Re: Public Hearing – CDBG Application for Granite Falls Workforce Training Center

Chairman Fore announced this was the date and time scheduled for a second public hearing on the CDBG Application for Granite Falls Workforce Training Center. Notice of this hearing was advertised according to law in the March 18, 2011 and March 23, 2011 issues of THE FARMVILLE HERALD, a newspaper published in the County of Prince Edward.

Sharon Lee Carney, Director of Economic Development, said Prince Edward County has an opportunity to apply for a Community Development Block Grant from the Virginia Department of Housing and Community Development (VDHCD) in the amount of \$700,000 to build a “community service facility” to be known as the Granite Falls Workforce Training Center. This training facility will be part of

the public/private partnership known as the Granite Falls Workforce Training Center. The grant submittal date is March 31, 2011.

Mrs. Carney said while there is no specific matching fund requirement, the grant will score more favorably with a higher match pledge. The estimated cost of just the workforce training center is \$2.7 million. The total project estimated costs are \$44 million +/-, creating 95 full time equivalent job positions and should offer educational opportunities for 756 students annually, as per estimates by Southside Virginia Community College (SVCC). This does not represent the number of indirect jobs to be created and local economic impact to area companies and tradesmen associated with the development of the project. In addition, more than 100 jobs are estimated to be created as a result of the project construction phase.

The remaining funding sources for the Workforce Training Center include \$1,645,848 in Tobacco Commission funds already awarded for construction, \$150,000 in a USDA Distance Learning Grant for equipment (to be applied for in 2012) and potentially a small IDA financing to cover any financial shortfall for construction that is not to exceed \$204,152, as per a guaranteed maximum price by WM Jordan Construction. This loan amount may be less depending on construction bid prices. The IDA borrowing will not be a liability to the County of Prince Edward. Submittal of the grant application does not represent an obligation to accept the funds, if awarded, or any financial obligation if other funding sources do not materialize.

Chairman Fore opened the public hearing on the CDBG Application for Granite Falls Workforce Training Center.

Wanda Whitus spoke in favor of the project.

Andre Gilliam spoke in favor of the project and stated he is honored to help the County with this project, which provides a community service facility.

There being no one further wishing to speak, Chairman Fore closed the public hearing.

Supervisor Simpson made a motion to authorize the submittal of a CDBG application in the amount of \$700,000 to VDHCD for the Granite Falls Workforce Training Center through the adoption of the grant resolution, and to authorize the Board of Supervisors Chairman and/or County Administrator to sign all necessary grant documents to execute the application, grant reports and grant contract; the motion carried:

Aye: Howard M. Campbell
William G. Fore, Jr.
Don C. Gantt
Robert M. Jones
Charles W. McKay
Howard F. Simpson
Jim R. Wilck
Mattie P. Wiley

Nay: None

**A RESOLUTION OF THE BOARD OF SUPERVISORS
OF THE COUNTY OF PRINCE EDWARD, VIRGINIA**

**VIRGINIA DEPARTMENT OF HOUSING AND COMMUNITY
DEVELOPMENT
CDBG GRANT ENDORSEMENT RESOLUTION**

WHEREAS, the Virginia Department of Housing and Community Development (VDHCD) was created to help foster community economic development, job creation opportunities for low-to-moderate income citizens and eradicate slum and blight in the Commonwealth of Virginia; and

WHEREAS, the Board of Supervisors of the County of Prince Edward, Virginia, wishes to submit a grant application to VDHCD for a Community Development Block Grant (CDBG) in the amount of \$700,000 for the construction of a workforce training center as a “Community Service Facility, which is due March 31, 2011; and

WHEREAS, the “Community Service Facility” will be part of a public/private partnership known as the Granite Falls Hotel Conference and Workforce Training Center. The total project estimated costs are \$44 million +/-, creating 95 full time equivalent job positions (FTEs) and should offer educational opportunities for 756 students annually, as per estimates by Southside Virginia Community College (SVCC). This does not represent the number of indirect jobs to be created and local economic impact to area companies and tradesmen associated with the development of the project. In addition more than 100 jobs are estimated to be created as a result of the project construction phase.

NOW, THEREFORE, BE IT RESOLVED, that the Board of Supervisors of the County of Prince Edward, Virginia, does hereby support a grant application to VDHCD for CDBG funding in the amount of \$700,000 to help build the workforce training center to be known as the Granite Falls Workforce Training Center; and

BE IT FURTHER RESOLVED, that the Board of Supervisors of the County of Prince Edward, Virginia, does hereby authorize the Chairman of the Board of Supervisors and/or County Administrator to sign any and all necessary grant documents to execute the application, grant reports and grant contract.

On motion of Supervisor McKay and adopted by the following vote:

Aye:	Howard M. Campbell	Nay: None
	William G. Fore, Jr.	
	Don C. Gantt	
	Robert M. Jones	
	Charles W. McKay	
	Howard F. Simpson	
	Jim R. Wilck	
	Mattie P. Wiley	

the meeting was adjourned at 5:14 p.m.

DRAFT

April 5, 2011

At a called meeting of the Board of Supervisors of Prince Edward County, held at the Court House, thereof, on Tuesday, the 5th day of April, 2011; at 2:00 p.m., there were present:

Howard M. Campbell

William G. Fore, Jr.

Don C. Gantt, Jr.

Robert M. Jones

Charles W. McKay

Howard F. Simpson

Jim R. Wilck

Mattie P. Wiley

Also present: Wade Bartlett, County Administrator.

Chairman Fore called the Special Meeting to order at 2:00 p.m. for a budget work session and donation requests funded by the County General Fund.

In Re: Budget Presentations

The following FY 2011-2012 donation requests were presented:

Virginia Legal Aid	\$ 4,000.00
STEPS	27,232.00
Crossroads Community Services	62,643.00
Longwood Visual Arts	2,496.00
PE-FA Youth Association	24,000.00
Habitat for Humanity	5,000.00
Madeline's House	7,000.00
Farmville Chamber of Commerce	5,000.00
Longwood Small Business	7,074.00

HOPE	10,000.00
Farmville/Prince Edward Library	195,000.00
Heart of Virginia Festival	3,500.00
R. R. Moton Museum	100,000.00
Piedmont Soil & Water District	10,000.00 – Operations 5,000.00 -Dam Maintenance
Old Dominion RC&D	1,775.00
Special Olympics	200.00
Mary E. Branch Community Center	50,000.00
SCOPE/Meals on Wheels	5,000.00
FACES	4,275.00
YMCA	24,000 Summer Program 36,000.00 County Program
Piedmont Area Transit	10,000.00
Pamplin Community Center	475.00
Farmville Volunteer Fire Department	53,000.00 Operations 15,000 Equipment
Rice Volunteer Fire Department	53,000.00 Operations 15,000 Equipment
Prospect Volunteer Fire Department	53,000.00 Operations 15,000 Equipment
Hampden-Sydney Volunteer Fire Department	56,500.00 Operations 15,000 Equipment
Darlington Heights Volunteer Fire Department	53,000.00 Operations 15,000 Equipment
Meherrin Volunteer Fire Department	53,000.00 Operations 15,000 Equipment
Pamplin Volunteer Fire Department	53,000.00 Operations 15,000 Equipment
Prince Edward Firefighters Association	6,000.00
Prince Edward Rescue Squad	60,000.00
Meherrin Rescue Squad	10,000.00
Pamplin Volunteer EMS	10,000.00

Hampden-Sydney 1 st Responder	5,000.00
Burkeville Volunteer Fire Department	1,500.00
Chesterfield County Med-Flight	500.00
Old Dominion EMS Alliance	3,569.00 (Includes 10% Four-for-Life Funds)
Prince Edward County After-Prom	1,000.00
Fuqua After-Prom	475.00
Tri-County Life Learners	3,325.00
Piedmont Senior Resources	1,616.00
Jolly Glee Senior Citizens	1,900.00
Commonwealth Regional Council	15,700.00
SVCC	5,203.00
Heart of Virginia Fireworks	2,500.00
Youth Empowerment Center, Inc.	30,000.00

In Re: Meeting Minutes

Chairman Fore stated a copy of the approved minutes must accompany the Redistricting package which is being prepared for judicial review.

Supervisor Gantt made a motion to accept the minutes of the meeting held March 8, 2011; the motion carried:

Aye:	Howard M. Campbell William G. Fore, Jr. Don C. Gantt, Jr. Robert M. Jones Charles W. McKay Howard F. Simpson Jim R. Wilck Mattie P. Wiley	Nay: None
------	--	-----------

In Re: Pre-Clearance Public Notice

Supervisor Wiley made a motion to authorize the County Administrator to advertise notice of the County seeking pre-clearance from the U. S. Justice Department of its redistricting plan; the motion carried:

Aye: Howard M. Campbell
William G. Fore, Jr.
Don C. Gantt, Jr.
Robert M. Jones
Charles W. McKay
Howard F. Simpson
Jim R. Wilck
Mattie P. Wiley

Nay: None

In Re: FY12 County Budget Public Hearing

Supervisor Wilck made a motion to advertise the proposed county budget as presented by the County Administrator, with an operating budget of \$57,277,854; the motion carried:

Aye: Howard M. Campbell
William G. Fore, Jr.
Don C. Gantt, Jr.
Robert M. Jones
Charles W. McKay
Howard F. Simpson
Jim R. Wilck
Mattie P. Wiley

Nay: None

- GENERAL FUND -

ANTICIPATED REVENUES:

Revenue from Local Sources:	
General Property Taxes	\$10,038,194
Other Local Taxes	3,734,500
Permits and Licenses	75,400
Fines and Forfeitures	46,700
Revenue from Use of Money & Property	378,102
Charges for Services	534,700
Miscellaneous Income	25,527
Recovered Costs	220,868
From General Fund Balance	386,174
Transfer From IDA Fund	26,692
Revenue from the Commonwealth	<u>4,145,734</u>
TOTAL GENERAL FUND REVENUES	\$19,612,591

PROPOSED EXPENDITURES:

Board of Supervisors	119,860
County Administration	474,679
Legal, Audit, Assessor	117,643
Information Technology	102,880

Commissioner of Revenue	274,191
Treasurer	358,687
Board of Elections/Registrar	132,865
Circuit Court	53,750
Combined Courts	9,850
Magistrates	3,725
Clerk of Circuit Court	453,329
Law Library	4,300
Commonwealth's Attorney	604,396
Victim Witness	56,279
Sheriff	2,008,146
Emergency Services	45,917
Fire Departments	487,800
Rescue Squads	76,500
Forest Fire Service	14,448
Corrections and Detention	195,000
Building Official	93,064
Animal Control	124,390
Medical Examiner	500
Landfill Operations/Convenience Centers	1,176,265
Biosolids	87,449
Sandy River Reservoir	30,000
General Properties	684,516
Health Department	167,761
Crossroads CSB	62,643
Comprehensive Services Act	906,326
Donations to Community Programs	71,236
Contributions of Colleges (SVCC, LU)	12,277
Parks, Recreation, and Cultural	85,350
Library	166,559
Planning	185,340
Community Development	44,250
Economic Development & Tourism	174,575
Soil & Water	11,465
Extension Service	61,192
Cannery	55,582
General Expense	245,075
Capital Projects	49,000
Transfer to Social Services Fund	578,943
Transfer to School Fund	7,880,132
Transfer to IDA Fund	149,057
Transfer to Retiree Fund	25,176
Debt Service	712,493
Donation to the Commonwealth of Virginia	<u>177,730</u>
TOTAL GENERAL FUND EXPENDITURES	\$19,612,591

- SCHOOL FUND -

ANTICIPATED REVENUES:

Other Sources	\$245,290
Revenue from the Commonwealth	14,983,944
Revenue from the Federal Government	3,652,091
Transfer from County General Fund	<u>7,880,132</u>
Total Anticipated Revenues	\$26,761,457

PROPOSED EXPENDITURES:

Instruction	\$20,249,190
Administration, Health, Attendance	1,685,315
Pupil Transportation	1,863,765
Operations & Maintenance	2,039,820
School Food Program	11,760
Facilities	150,000
Debt Service	<u>761,607</u>
Total Proposed Expenditures	\$26,761,457

- SCHOOL CAFETERIA FUND -

ANTICIPATED REVENUES:

Cafeteria Sales	\$244,671
Revenue from the Commonwealth	22,399
Revenue from the Federal Government	<u>820,000</u>
Total Anticipated Revenues	\$1,087,070
Total Proposed Expenditures	\$1,087,070

- SOCIAL SERVICES FUND -

ANTICIPATED REVENUES:

Revenue from the Commonwealth	\$791,645
Revenue from the Federal Government	1,380,588
Transfer from County General Fund	578,943
Recovered Cost	<u>10,000</u>
Total Anticipated Revenues	\$2,761,176
Total Proposed Expenditures	\$2,761,176

- WATER FUND -

ANTICIPATED REVENUES:

Charges for Service	\$ 1,600
Series 10 Revenue Note	850,000
Series 11 Bond	<u>3,393,400</u>
Total Anticipated Revenues	\$4,245,000

PROPOSED EXPENDITURES:

Operations & Maintenance	\$5,400
Wholesale Purchase of Water	1,400
Depreciation	25,000
Debt Service	3,831,103
To Fund Balance	<u>382,097</u>
Total Proposed Expenditures	\$4,245,000

- SEWER FUND -

ANTICIPATED REVENUES:

Charges for Service	\$ 3,200
Series 11 Bond	1,306,600
From Sewer Fund Balance	<u>148,312</u>
Total Anticipated Revenues	\$ 1,458,112

PROPOSED EXPENDITURES:

Operations & Maintenance	\$ 5,900
Wholesale Purchase of Water	1,680
Depreciation	25,000
Debt Service	<u>1,425,532</u>
Total Proposed Expenditures	\$ 1,458,112

- LANDFILL CONSTRUCTION FUND -

ANTICIPATED REVENUES	
Charges to Customers/Interest	\$ 276,000
From Landfill Construction Fund Balance	<u>524,000</u>
Total Anticipated Revenues	\$ 800,000
 Total Proposed Expenditures	 \$800,000

- RETIREE BENEFITS FUND -

Total Anticipated Revenues	\$25,176
Total Proposed Expenditures	\$25,176

- PIEDMONT COURT SERVICES FUND -

Total Anticipated Revenues	\$527,272
Total Proposed Expenditures	\$527,272

TOTAL COUNTY OPERATIONS FOR FY12 **\$57,277,854**

PROPOSED TAX RATES

Notice is hereby given that the Board of Supervisors of Prince Edward County, Virginia, proposes the following tax levies for the tax year 2011:

Unit Levy—All Districts—Per \$100 Assessed Valuations

<u>Levy:</u>	<u>2010 Actual Levy</u>	<u>2011 Proposed Levy</u>
Real Estate	\$0.42	\$0.42
Tangible Personal Property	\$4.50	\$4.50
Machinery & Tools	\$4.20	\$4.20
Merchant's Capital	\$0.70	\$0.70
Farm Machinery & Livestock	\$0.00	\$0.00

On motion of Supervisor Simpson and adopted by the following vote:

Aye: Howard M. Campbell William G. Fore, Jr. Don C. Gantt, Jr. Robert M. Jones Charles W. McKay Howard F. Simpson Jim R. Wilck Mattie P. Wiley	Nay: None
---	-----------

the meeting was adjourned at 4:55 p.m.

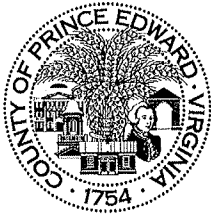

**County of Prince Edward
Board of Supervisors
Agenda Summary**

Meeting Date: April 12, 2011
Item No.: 5-c
Department: County Administration
Staff Contact: Barbara Poulston
Issue: Consent Agenda - Review of Accounts & Claims

Summary: The bill list for March 2011 is attached for your review.

Attachments: March 2011 Bill List

Recommendation: None.

Motion _____
Second _____

Campbell _____
Jones _____
Wilck _____

Fore _____
McKay _____
Wiley _____

Gantt _____
Simpson _____

3/31/2011

FROM DATE- 3/18/2011
TO DATE- 3/31/2011

ACCOUNTS PAYABLE CHECKS
PRINCE EDWARD

PAGE 1

FUND NO.	DESCRIPTION	\$\$\$ PAY \$\$\$
100	GENERAL FUND	\$213,021.00
501	WATER FUND	\$325.48
502	SEWER FUND	\$31.37
732	RETIREMENT BENEFIT FUND	\$1,020.00
740	REVENUE SHARING-VDOT FUND	\$37,459.00
741	PIEDMONT COURT SERVICES FUND	\$3,515.48
	TOTAL	255,372.33

MAJOR#	VENDOR NUMBER	VENDOR NAME	INV#	DESCRIPTION	AMOUNT
012050	29332	MOTOR VEHICLE LICENSE TAXES	2011	DECALS	60,095.00 *
		Motor Vehicle Licenses-20			60,095.00 *
		TOWN OF FARMVILLE			60,095.00 **
012110		COUNTY ADMINISTRATOR			
5230	10105	Telecommunications			
	12747	AT&T	392 8837 311	PHONE	39.83
	21319	COMMWORLD CENTRAL VA	25018	PHONE SERVICE LABOR	200.00
	23933	CENTURYLINK	310116752 311	PHONE	66.30
	30439	NTELOS	165866886 311	PHONE	2,719.94
		US CELLULAR	816442183 311	PHONE	75.28
5510	22151	Travel-Mileage			3,101.35 *
		MARTIN SHEILA	MILEAGE 311	MILEAGE	54.57
6001	11894	Office Supplies			54.57 *
	13369	BUSINESS CARD	1412 PUCKETT311	COPIES OF MAPS	110.99
		DIAMOND SPRINGS	11393100 311	WATER & EQUIP RENTAL	15.70
6012	15240	Books and Subscriptions			126.69 *
		FARMVILLE HERALD	CO ADMR 311	SUBSCRIPTION	38.00
012310		COMMISSIONER OF REVENUE			38.00 *
5230	10105	Telecommunications			3,320.61 **
	13325	AT&T	392 3231 311	PHONE	27.04
		TREASURER OF VIRGINIA	T231549	ONLINE SERVICE	78.05
012410		TREASURER			105.09 *
3170	14691	Land Sale Expense			105.09 **
		ELLIOTT JAMES W ATTY	MARCH 14 2011	AD & COURT COSTS	445.00
5210	28220	Postal Services			445.00 *
		SHANABERGER MABLE	POSTAGE 311	POSTAGE	50.40
5230	10105	Telecommunications			50.40 *
	10105	AT&T	392 3454 311	PHONE	34.77
	13325	TREASURER OF VIRGINIA	392 3454 311A	PHONE	39.83
	21319	CENTURYLINK	T231549	ONLINE SERVICE	78.06
			309344949 311	PHONE	101.40
					254.06 *
				ACCOUNT TOTAL	
				MAJOR TOTAL	

MAJOR#	ACCT#	VENDOR NUMBER	VENDOR NAME	INV#	DESCRIPTION	AMOUNT
5410	25483	PITNEY BOWES	LEASE/Rent Equipment	6924195	EQUIPMENT LEASE	1,002.00 *
5510	21547	LEE BARBARA	Travel-Mileage	MILEAGE 311	MILEAGE & TOLLS	77.36 *
5540	30378	UNIVERSITY OF VIRGINIA	Travel-Convention & Educa	6342	TRAINING MTG	65.00 *
012510			INFORMATION TECHNOLOGY			1,893.82 **
3160			Professional Services			
	11902		BUSINESS DATA OF VA, INC.	20100573	TRAVEL EXPENSE	125.00
	11902		BUSINESS DATA OF VA, INC.	20100575	TRAVEL EXPENSE	125.00
	11902		BUSINESS DATA OF VA, INC.	20100585	TRAVEL EXPENSE	125.00
	11902		BUSINESS DATA OF VA, INC.	20100586	TRAVEL EXPENSE	125.00
	11902		BUSINESS DATA OF VA, INC.	20100587	TRAVEL EXPENSE	125.00
	11902		BUSINESS DATA OF VA, INC.	20100588	TRAVEL EXPENSE	125.00
	11902		BUSINESS DATA OF VA, INC.	20100589	TRAVEL EXPENSE	125.00
	11902		BUSINESS DATA OF VA, INC.	20100590	TRAVEL EXPENSE	75.00
	11902		BUSINESS DATA OF VA, INC.	20100606	TRAVEL EXPENSE	125.00
	11902		BUSINESS DATA OF VA, INC.	2100580	TRAVEL EXPENSE	125.00
					ACCOUNT TOTAL	1,200.00 *
					MAJOR TOTAL	1,200.00 **
021200			GENERAL DISTRICT COURT			
5230			Telecommunications			
	10105		AT&T	392 4024	PHONE-GEN DIST COURT	39.85
	21319		CENTURYLINK	310039005	PHONE-GEN DIST COURT	78.46
	30439		US CELLULAR	816442183	PHONE	27.88
					ACCOUNT TOTAL	146.19 *
					MAJOR TOTAL	146.19 **
021500			CLERK OF THE CIRCUIT COURT			
3310			Repairs/Maintenance			
	18663		ILS/MANATRON INC	INVC041725	ANNUAL MAINTENANCE	4,829.93
	18663		ILS/MANATRON INC	55293	APC BACKUP BATTERY	78.06
					ACCOUNT TOTAL	4,907.99 *
5230			Telecommunications			
	10105		AT&T	392 5145	PHONE	39.83
	21319		CENTURYLINK	309863799	PHONE	76.96
					ACCOUNT TOTAL	116.79 *
5880			Technology Trust Funds			
	18663		ILS/MANATRON INC	INVC041725	ANNUAL MAINTENANCE	2,556.88
					ACCOUNT TOTAL	2,556.88 *

AP375H
3/31/2011
FUND # - 100 GENERAL FUND

PRINCE EDWARD
LISTING OF INVOICES FOR 3/18/2011 -- 3/31/2011

AFTER CHECKS
PAGE 3

MAJOR# ACCT#	VENDOR NUMBER	VENDOR NAME	DESCRIPTION	INV#	AMOUNT
6012	18663	Books and Subscriptions ILS/MANATRON INC	PLAT SCANNING	55228	40.00 40.00 * 7,621.66 **
021800	LAW LIBRARY				
5230	10105 21319	Telecommunications AT&T CENTURYLINK	PHONE PHONE	315 0208 311 309478607 311	34.77 34.89 69.66 * 69.66 **
022100	COMMONWEALTH'S ATTORNEY				
5230	20904	Telecommunications KINEX NETWORKING SOLUTION	INTERNET	110314 0008	49.95 49.95 *
5510	11943 14746 16819 22115	Travel-Mileage BUTLER BRIAN ENNIS JAMES R GREER MORGAN MANN EDWARD A	MILEAGE MILEAGE MILEAGE MILEAGE & TOLLS	EXPENSES 311 EXPENSES 311 EXPENSES 311 EXPENSES 311	137.70 160.14 121.38 143.45 562.67 *
5530	11943 11943 14746 14746 16819 16819 22115 22115	Travel-Subsistence & Lodg BUTLER BRIAN BUTLER BRIAN ENNIS JAMES R ENNIS JAMES R GREER MORGAN GREER MORGAN MANN EDWARD A MANN EDWARD A	LODGING MEALS LODGING MEALS LODGING MEALS LODGING MEALS	EXPENSES 311 EXPENSES 311 EXPENSES 311 EXPENSES 311 EXPENSES 311 EXPENSES 311 EXPENSES 311 EXPENSES 311	261.86 103.62 344.06 154.50 261.36 94.73 261.86 88.20 1,570.19 *
5899	999999	Miscellaneous BANK OF AMERICA	COPY OF BANK RECORDS	BANK RECORDS	27.82 27.82 *
6012	21735	Books and Subscriptions LEGAL DIRECTRIES PUBLISH	2011 LEGAL DIRECTORY	11 DIRECTORY	57.75 57.75 * 2,268.38 **
031200	SHERIFF				
3311	14300 14300 14300 14300	Repairs & Maint-Auto & Eq EAST END MOTOR CO INC EAST END MOTOR CO INC EAST END MOTOR CO INC EAST END MOTOR CO INC	OIL CHANGE/FLUIDS INSPECTION/HEADLIGHT REPAIR REAR SIGNAL RELINE BRAKES/ROTORS	69822 69995 70140 70168	76.57 52.89 15.65 464.70

AP375H
3/31/2011
FUND # - 100 GENERAL FUND

PRINCE EDWARD
LISTING OF INVOICES FOR 3/18/2011 -- 3/31/2011

AFTER CHECKS
PAGE 4

MAJOR# ACCT#	VENDOR NUMBER	VENDOR NAME	INV#	DESCRIPTION	AMOUNT
5230	14300	EAST END MOTOR CO INC	70364	SENSOR/FAN MOTOR	930.41
	14300	EAST END MOTOR CO INC	70823	OIL CHANGE	42.66
	14300	EAST END MOTOR CO INC	70919	COOLING FAN & MODULE	628.97
	14300	EAST END MOTOR CO INC	71066	INSPECTION/WIPER BLD	40.98
	14300	EAST END MOTOR CO INC	71092	INSPECTION	16.00
	14915	EXPRESS CARE	44445	OIL CHANGE	38.99
	14915	EXPRESS CARE	44473	OIL CHANGE	55.10
	15920	FOURTH STREET MOTOR CO	SHERIFF 311	AUTO REPAIRS	6,285.57
	17403	HARRIS TRAVIS III	SHERIFF 04 FORD	OIL CHANGE/FILTERS	102.97
	17403	HARRIS TRAVIS III	SHERIFF 06 FORD	HEADLIGHT/OIL CHANGE	88.73
	999999	NAPIER TOWING	TOWING 311	TOWING SERVICE	75.00
				ACCOUNT TOTAL	8,915.19 *
5530	12188	Telecommunications		PHONE & ACCESSORIES	164.89
	20905	CARRINGTON'S CELLULAR	250 311	WEBHOSTING/BACKUP	106.44
	21319	KINEX TELECOM INC	110301 0021	PHONE	62.37
		CENTURYLINK	309625478 311		333.70 *
				ACCOUNT TOTAL	16.88 *
5801	11894	Travel-Subsistence & Lodg		MEALS	16.88 *
		BUSINESS CARD	0555 SHERIFF311		16.88 *
6001	11894	Accreditation		BUSINESS CARDS	26.49
	11894	BUSINESS CARD	0555 SHERIFF311	MEETING SUPPLIES	18.06
	32131	WAL-MART COMMUNITY	2117 SHERIFF311		44.55 *
				ACCOUNT TOTAL	19.60
6009	11894	Office Supplies		FEEES	92.85
	13369	BUSINESS CARD	0555 SHERIFF311	WATER & EQUIP RENTAL	159.47
	28757	DIAMOND SPRINGS	27961300 311	OFFICE SUPPLIES	679.58
	29137	STAPLES ADVANTAGE	8017820595	LIVESCAN TONER	71.02
	32131	THE PRODUCT CENTER	476354710	OFFICE SUPPLIES	1,022.52 *
	32131	WAL-MART COMMUNITY	2117 SHERIFF311		141.28
				ACCOUNT TOTAL	395.48
6010	14300	Vehicle & Powered Equip S		TIRE	19.98
	14300	EAST END MOTOR CO INC	69856	TIRES	556.74 *
	15150	EAST END MOTOR CO INC	70460	WIPER BLADES	1,981.51
		FARMVILLE AUTO PARTS	48888	CAR CAMERA DVD'S	132.00
				TASERS	2,434.85
				ACCOUNT TOTAL	4,548.36 *
6011	11894	Police Supplies		UNIFORMS	93.03
	11894	BUSINESS CARD	0555 SHERIFF311	BELT	37.00
	21038	BUSINESS CARD	436542		130.03 *
	28592	KUSTOM SIGNALS INC	146982	SOFTWARE	499.00
		SOUTHERN POLICE EQUIP CO		COMPUTER	1,424.85
				ACCOUNT TOTAL	1,923.85 *
6040	11894	Uniforms & Wearing Appare		MAJOR TOTAL	17,491.82 **
	11894	BUSINESS CARD	0555 SHERIFF311		
	12726	SOUTHERN POLICE EQUIP CO	146983		
		ADP Equipment			
		BUSINESS CARD	0555 SHERIFF311		
		COMPRO COMPUTERS	1113		

AP375H
3/31/2011
FUND # - 100 GENERAL FUND

PRINCE EDWARD
LISTING OF INVOICES FOR 3/18/2011 -- 3/31/2011

AFTER CHECKS
PAGE 5

MAJOR#	VENDOR NUMBER	VENDOR NAME	INV#	DESCRIPTION	AMOUNT
7002	14527	ELECOM INC	31082	PAGER REPAIR	105.00
	14527	ELECOM INC	31083	PAGER REPAIR	99.80
	15009	FARM PLAN	54860	PROPANE	202.50
	15009	FARM PLAN	65592	DIESEL	251.99
	15009	FARM PLAN	70982	DIESEL	99.01
	15009	FARM PLAN	70984	GAS	260.05
	25246	PARKER OIL CO INC	28454	DIESEL	703.52
	25246	PARKER OIL CO INC	28503	GAS	513.50
	28091	SCHMIDT'S REPAIR SERVICE	699	INSPECTION	153.00
	31368	VFIS	56123	COMMERCIAL EXCESS	187.00
	31368	VFIS	56124	PACKAGE INSURANCE	2,265.00
	31844	DOMINION VA POWER	4500495009 311	ELECTRIC SERVICE	202.37
	31846	DOMINION VA POWER	5487358649 311	ELECTRIC SERVICE	8.98
				ACCOUNT TOTAL	5,051.72 *
7003	10851	Payment to Prospect VFD		CHARGER REPAIRS	238.58
	11240	ATLANTIC EMERGENCY	KOS2089P	TRUCK CHASSIS LOAN	5,000.00
	15596	BENCHMARK COMMUNITY BANK	PROSPECT PAY #1	HEATER INSTALL PARTS	32.53
	15596	FERGUSON ENTERPRISES INC	2068375	WORKLIGHT & BULB	17.17
	16658	FERGUSON ENTERPRISES INC	2076497	TRUCK REPAIRS	73.37
	16658	GOODMAN TRUCK & TRACTOR	331017	AIR BRAKE REPAIR	3,749.40
	16658	GOODMAN TRUCK & TRACTOR	99074	PHONE	89.83
	21319	CENTURYLINK	309983930 311	FUEL	142.22
	25210	PAMPLIN EXXON	PROSPECT FD 311	PROPANE	781.89
	25247	PARKER OIL COMPANY INC	30702	FUEL	368.89
	29332	TOWN OF FARMVILLE	805 PROSPECT311	CHAIRS	255.00
	29501	TREASURER OF VIRGINIA	R35218	CHAIRS	120.00
	29501	TREASURER OF VIRGINIA	SR07060	CHAIRS	10,868.88 *
				ACCOUNT TOTAL	10,868.88 *
7006	10105	Payment to Pamplin VFD		PHONE	37.67
	12758	AT&T	248 6690 311	RADIO PART	39.20
	15656	COMMTRONICS OF VA	196959	AIRPACK TEST	70.00
	15908	FIRE & SAFETY EQUIP CO	31978	PROPANE	373.00
	15908	FOSTER FUELS INC	192159	PROPANE	459.33
	15908	FOSTER FUELS INC	192305	PROPANE	429.44
	15908	FOSTER FUELS INC	192981	PROPANE	412.74
	25200	PAMPLIN VOL FIRE DEPT	REIMB 311	FUEL	68.89
	25200	PAMPLIN VOL FIRE DEPT	REIMB 311	MTG SUPPLIES	24.95
	25200	PAMPLIN VOL FIRE DEPT	REIMB 311	INTERNET	350.00
	25910	PRO AUTO ELECTRIC INC	27228	TRUCK REPAIRS	63.98
	31335	VERIZON	248 6100 311	PHONE	52.60
	31335	VERIZON	248 6690 311	PHONE	1,576.00
	31359	WEST'S SALE & SERVICE INC	9105	ANNUAL PUMP MAINT	141.00
	31359	WEST'S SALE & SERVICE INC	9158	BOOTS	204.94
	31846	DOMINION VA POWER	4743517221 311	ELECTRIC SERVICE	32.62
	31846	DOMINION VA POWER	6280980001 311	ELECTRIC SERVICE	4,336.36 *
				ACCOUNT TOTAL	20,256.96 **
				MAJOR TOTAL	

AP375H
3/31/2011
FUND # - 100 GENERAL FUND

PRINCE EDWARD
LISTING OF INVOICES FOR 3/18/2011 -- 3/31/2011

AFTER CHECKS
PAGE 6

MAJOR# ACCT# 032500	VENDOR NUMBER EMERGENCY SERVICES	VENDOR NAME EMERGENCY SERVICES	INV#	DESCRIPTION	AMOUNT
3160	29280	Professional Service E-91 TIMMONS GROUP	136655	SYSTEM MAINTENANCE	90.00 90.00 * 90.00 **
033200		REGIONAL JAIL & DETENTION			
3196		Purchase of Services - Ja FAMILY PRESERVATION SERV FAMILY PRESERVATION SERV FAMILY PRESERVATION SERV	48526 48528 48529	ELECTRONIC MONITORIN ELECTRONIC MONITORIN ELECTRONIC MONITORIN	420.00 840.00 420.00 1,680.00 * 1,680.00 **
034100		BUILDING OFFICIAL			
5230	30439	Telecommunications US CELLULAR	816442183 311	PHONE	33.63 33.63 *
5510	21498	Travel-Mileage LEATHERWOOD COY	EXPENSES 311	MILEAGE	31.00 31.00 *
5530	21498	Travel-Subsistence & Lodg LEATHERWOOD COY	EXPENSES 311	MEALS	18.45 18.45 *
5540	21498	Travel-Convention & Educa LEATHERWOOD COY	EXPENSES 311	MTG REGISTRATIONS	30.00 30.00 * 113.08 **
035100		ANIMAL CONTROL			
5110	31844	Electrical Services DOMINION VA POWER	0890745003 311	ELECTRIC SERVICE	277.81 277.81 *
5230	21319 30439	Telecommunications CENTURYLINK US CELLULAR	310119726 311 816442183 311	PHONE PHONE	116.48 66.46 182.94 *
5540	999999	Travel-Convention & Educa CRATER CRIMINAL JUSTICE	71	TRAINING	500.00 500.00 *
6002	32138	Supplies for Shelter WAL-MART COMMUNITY/GEMB	2238 CO ADM 311	DOG FOOD	127.76 127.76 *
6005	32138	Janitorial Supplies WAL-MART COMMUNITY/GEMB	2238 CO ADM 311	BLEACH	14.03 14.03 *

MAJOR#	VENDOR NUMBER	VENDOR NAME	DESCRIPTION	INVOICE#	AMOUNT
036100	11894	BUSINESS CARD	TRAPS	1412 PUCKETT311	389.98
					389.98 *
					1,492.52 **
					ACCOUNT TOTAL
					MAJOR TOTAL
5230	30439	Telecommunications	PHONE	816442183 311	31.13
					31.13 *
					31.13 **
					ACCOUNT TOTAL
					MAJOR TOTAL
042300		REFUSE DISPOSAL			
3160	27191	Professional Services	MISC WORK TASKS	37152	1,268.50
	27191	RESOURCE INTERNATIONAL	STORM WTR COMPLIANCE	37153	122.00
					1,390.50 *
					ACCOUNT TOTAL
3310	15860	Repairs/Maintenance	STRAPS & J-HOOKS	MARCH 23 2011	97.20
	15860	FMHS INC	RETURN	MARCH 29 2011	24.30-
	21811	LOWE'S	BROOM	909736	10.99
	22669	MOORE SCALE SRV-WSTRN VA	BALANCE/TEST SCALES	3813	922.20
	23792	W C NEWMAN CO INC	CONCRETE	3588	181.30
	25680	PRICE SUPPLY CO INC	COUPLING & BUSHING	794574	5.32
					1,192.71 *
					ACCOUNT TOTAL
3311	12032	Repairs & Maint-Auto & Eq	REPAIR TARP COVER	158871	268.10
	19033	C & L MACHINE & WELDING	EXHAUST PIPE	MARCH 9 2011	426.42
					694.52 *
					ACCOUNT TOTAL
3840	10811	Contract Landfill - POS	TRASH COLLECTION	MARCH 2011	289.00
	27191	ARENA TRUCKING COMPANY	GROUNDWTR MONITORING	37068	10,863.31
		RESOURCE INTERNATIONAL			11,152.31 *
					ACCOUNT TOTAL
3841	14723	Purchase of Serv - Recycli	TIRE RECYCLING	467190	504.00
	14723	EMANUEL TIRE OF VIRGINIA	TIRE RECYCLING	467296	561.60
					1,065.60 *
					ACCOUNT TOTAL
5110	28640	Electrical Services	DH SITE	114379 001 311	128.26
	31844	SOUTHSIDE ELECTRIC COOP	LEACHATE PUMP	5181167213 311	5.81
	31844	DOMINION VA POWER	SCALEHOUSE	8970737501 311	102.74
	31846	DOMINION VA POWER	RICE SITE	0599507431 311	107.17
	31846	DOMINION VA POWER	CELL C PUMP STATION	0670040567 311	18.19
	31846	DOMINION VA POWER	GREEN BAY SITE	1144204110 311	75.44
	31846	DOMINION VA POWER	WORSHAM SITE	5856894620 311	57.03
	31846	DOMINION VA POWER	WORSHAM SITE	5856894620 311C	57.03-
	31846	DOMINION VA POWER	WORSHAM SITE	7471653571 311	87.96
	31846	DOMINION VA POWER	PROSPECT SITE	8601161519 311	90.49

AP375H
3/31/2011
FUND # - 100 GENERAL FUND

LISTING OF INVOICES FOR 3/18/2011 -- 3/31/2011

AFTER CHECKS
PAGE 8

MAJOR#	ACCT#	VENDOR NUMBER	VENDOR NAME	INV#	DESCRIPTION	AMOUNT
		31846	DOMINION VA POWER	9176847250 311	LANDFILL SITE	53.29
			Telecommunications			669.35 *
5230		10105	AT&T	223 1595 311	PHONE	43.55
		10105	AT&T	392 3675 311	PHONE	48.21
		10105	AT&T	392 9223 311	PHONE	34.77
		10105	AT&T	574 4166 311	PHONE	41.33
		21319	CENTURYLINK	309326764 311	PHONE	42.57
		21319	CENTURYLINK	309480181 311	PHONE	43.38
		21319	CENTURYLINK	309553498 311	PHONE	37.10
		21319	CENTURYLINK	309615846 311	PHONE	41.15
		21319	CENTURYLINK	309714661 311	PHONE	44.74
		21319	CENTURYLINK	310039285 311	PHONE	48.53
		27132	RANSON'S INC	10207832	PHONE FOR SCALEHOUSE	10.99
		30439	US CELLULAR	816442183 311	PHONE	31.13
		31335	VERIZON	248 5696 311	PHONE	53.41
		31335	VERIZON	736 2828 311	PHONE	72.73
					ACCOUNT TOTAL	593.59 *
5440			Portable Toilet Rental			
		28869	STIFF O O INC	1176	MONTHLY SERVICE	662.50
		28869	STIFF O O INC	1208	MONTHLY SERVICE	662.50
					ACCOUNT TOTAL	1,325.00 *
6009			Vehicle & Powered Equip S			
		14300	EAST END MOTOR CO INC	71933	TIRE	291.81
		14300	EAST END MOTOR CO INC	71936	TIRE	198.00
					ACCOUNT TOTAL	489.81 *
					MAJOR TOTAL	18,573.39 **
042610			SANDY RIVER RESERVOIR			
3160			Professional Services			
		32553	WILEY & WILSON	44453	PPEA ASSIST/NOV-FEB	600.00
					ACCOUNT TOTAL	600.00 *
3310			Repairs/Maintenance			
		13779	DRAPER ADEN ASSOCIATES	2011020182	DAM 12 INSPECTION	570.00
					ACCOUNT TOTAL	570.00 *
					MAJOR TOTAL	1,170.00 **
043200			GENERAL PROPERTIES			
3310			Repairs/Maintenance			
		24086	OK TERMITE & PEST CONTROL	MARCH 17 2011	EXTERMINATING SERVIC	150.00
					ACCOUNT TOTAL	150.00 *
3311			Repairs & Maint-Auto & Eq			
		13166	DAVIS PONTIAC	2684	INSPECT/REPLACE BULB	26.20
					ACCOUNT TOTAL	26.20 *
5110			Electrical Services			
		28640	SOUTHSIDE ELECTRIC COOP	114379 002 311	SRR LIGHTS	30.80
		31844	DOMINION VA POWER	1230385005 311	ROY CLARK MONUMENT	22.76

AP375H
3/31/2011
FUND # - 100 GENERAL FUND

PRINCE EDWARD
LISTING OF INVOICES FOR 3/18/2011 -- 3/31/2011

AFTER CHECKS
PAGE 9

MAJOR# ACCT#	VENDOR NUMBER NAME	INV#	DESCRIPTION	AMOUNT
5120	31844 DOMINION VA POWER	2786281903 311	COURTHOUSE	9,019.33
	31844 DOMINION VA POWER	9670710004 311	SHOP	37.07
	31846 DOMINION VA POWER	1545926683 311	SCOPE BLDG	207.67
	31846 DOMINION VA POWER	4951935099 311	SHERIFF DEPT SHED	5.50
	31846 DOMINION VA POWER	5856894620 311A	WORSHAM CLERK OFFICE	57.03
	31846 DOMINION VA POWER	6669158583 311	LIGHTS AT RICE	101.77
	31846 DOMINION VA POWER	8105475944 311	AG BLDG	1,499.17
			ACCOUNT TOTAL	10,981.10 *
	25247 Heating Services		FUEL OIL	397.36
	25247 PARKER OIL COMPANY INC	20351	FUEL OIL	5,298.88
	25247 PARKER OIL COMPANY INC	39300	FUEL OIL	5,047.14
			ACCOUNT TOTAL	10,743.38 *
5230	10105 Telecommunications		PHONE	34.78
	21319 AT&T	223 8665 311	LINE TO HOSPITAL	7.97
	21319 CENTURYLINK	309558628 311	PHONE	48.38
	21319 CENTURYLINK	310262069 311	PHONE	66.30
	21319 CENTURYLINK	310441360 311	PHONE	87.34
	30439 US CELLULAR	816442183 311	PHONE	244.77 *
5440	28869 Portable Toilet Rental		MONTHLY SERVICE	100.00
	28869 STIFF O O INC	1176	MONTHLY SERVICE	100.00
		1208	MONTHLY SERVICE	200.00 *
6005	21811 Janitorial Supplies		CLEANING SUPPLIES	73.99
	32550 LOWE'S	906962	JANITORIAL SUPPLIES	2,295.65
		1239283 01	JANITORIAL SUPPLIES	2,369.64 *
6007	12521 Repairs and Maintenance S		PULLEYS/FILE SET	71.95
	13369 COE WILLIAM S. JR	REIMB 311	WATER & EQUIP RENTAL	21.70
	17877 DIAMOND SPRINGS	11393100 311	ALARM SYSTEM BATTERY	263.50
	21811 HUDSON-PAYNE ELECTRONICS	11032401	CHAIR RAIL	100.56
	21811 LOWE'S	901398	TIE-DOWNS/TESTER	111.76
	21811 LOWE'S	901465	CHARGER	19.97
	21811 LOWE'S	908699	PAINT	69.70
	21811 LOWE'S	909736	BULBS & CAULK	9.10
	21811 LOWE'S	909821	STRAP/WIRE STRIPPER	13.25
	21811 LOWE'S	910866	DOOR ALARM	32.99
	27132 RANSON'S INC	10208436	PAINT REMOVER	31.98
	28352 SHERWIN WILLIAMS CO	62475	PAINT REMOVER	746.46 *
6009	14300 Vehicle & Powered Equip S		MOWER TIRE REPAIR	13.80
		71677	MOWER TIRE REPAIR	13.80 *
043400	CANNERY		ACCOUNT TOTAL	25,475.35 **
3310	12032 Repairs & Maintenance		MAJOR TOTAL	99.00
		158815	BOLTS/NUTS/WASHERS	

MAJOR# ACCT#	VENDOR NUMBER	VENDOR NAME	INV#	DESCRIPTION	AMOUNT
5110	28640	Electrical Services SOUTHSIDE ELECTRIC COOP	44435 001 311	ELECTRIC SERVICE	83.24 *
5120	25247	Heating Services PARKER OIL COMPANY INC	20403	FUEL OIL	83.24 *
5230	21319	Telecommunications CENTURYLINK	310248529 311	PHONE	1,018.90 *
6014	21811	Other Operating Supplies LOWE'S	901101	WASHERS/NUTS-FISHCLN	80.65 *
	21811	LOWE'S	901629	PAINT-FISH CLEANING	2.40
	21811	LOWE'S	901750	EQUIP PARTS-FISH CLN	25.95
	21811	LOWE'S	901778	PAINT/SCREWS-FISHCLN	43.90
	21811	LOWE'S	909821	NUTS-FISH CLNR EQUIP	32.55
	21811	LOWE'S	910866	EQUIP PARTS-FISH CLN	3.78
	21811	LOWE'S	911669	CREDIT	31.04
	27770	ROD & STAFF WELDING	36952	IRON-FISH CLEANING	18.15-
	27770	ROD & STAFF WELDING	36974	IRON-FISH CLEANING	52.50
	27770	ROD & STAFF WELDING	36981	IRON-FISH CLEANING	306.24
053500		COMPREHENSIVE SERVICES ACT		ACCOUNT TOTAL	495.21 *
3160		CSA Programs		MAJOR TOTAL	1,953.95 **
	12270	CASTING YOUR CARES LLC	MARCH 2011	FOSTER CARE	60.00
	12280	CENTRA HEALTH	5928 311	PROFESSIONAL SERVICE	1,900.00
	12280	CENTRA HEALTH	6002 311	PROFESSIONAL SERVICE	1,900.00
	12929	CROSSROADS SERVICES BD	FAPT/CPMT 311	PROFESSIONAL SERVICE	3,557.50
	14933	FAMILY PRESERVATION SERV	48534	PROFESSIONAL SERVICE	1,600.00
	14933	FAMILY PRESERVATION SERV	48536	PROFESSIONAL SERVICE	412.50
	14933	FAMILY PRESERVATION SERV	48546	PROFESSIONAL SERVICE	700.00
	14933	FAMILY PRESERVATION SERV	48551	PROFESSIONAL SERVICE	933.75
				ACCOUNT TOTAL	275.95 *
				ACCOUNT TOTAL	83.24 *
				ACCOUNT TOTAL	1,018.90 *
				ACCOUNT TOTAL	80.65 *
				ACCOUNT TOTAL	1,953.95 **

AP375H
3/31/2011
FUND # - 100 GENERAL FUND

PRINCE EDWARD
LISTING OF INVOICES FOR 3/18/2011 -- 3/31/2011

AFTER CHECKS
PAGE 11

MAJOR#	ACCT#	VENDOR NUMBER	VENDOR NAME	INV#	DESCRIPTION	AMOUNT
3180		14933	FAMILY PRESERVATION SERV	48554	PROFESSIONAL SERVICE	8.75
		16672	GRAFTON SCHOOL INC	1854 311	PROFESSIONAL SERVICE	4,002.50
		16672	GRAFTON SCHOOL INC	2068 311	PROFESSIONAL SERVICE	4,233.50
		16672	GRAFTON SCHOOL INC	3197 311	PROFESSIONAL SERVICE	3,888.50
		21805	LOGAN LETRICIA R	MARCH 2011	FOSTER CARE	666.00
		28447	SMITH I'SHAWN	MARCH 2011	FOSTER CARE	644.00
		31876	VSDB	42329	PROFESSIONAL SERVICE	2,424.55
		999999	EXTENDED CARE ASSOCIATES	MARCH 2011	FOSTER CARE	13.80
					ACCOUNT TOTAL	26,945.35 *
		28220	Administrative SHANABERGER MABLE	CSA 311	ADMINISTRATIVE FEE	150.00
					ACCOUNT TOTAL	150.00 *
					MAJOR TOTAL	27,095.35 **
081100			PLANNING			
3161		12628	Planning Commission	MARCH 16 2011	COMMISSION MTG	100.00
		16183	COLEMAN R SAMUEL	MARCH 16 2011	COMMISSION MTG	100.00
		16195	GILFILLAN SALLY W	MARCH 16 2011	COMMISSION MTG	100.00
		17883	GILLIAM DONALD B	MARCH 16 2011	COMMISSION MTG	100.00
		17883	HUNT PRESTON	MARCH 16 2011	COMMISSION MTG	100.00
		19875	JONES ROBERT M	MARCH 16 2011	COMMISSION MTG	100.00
		22170	MASON ROBERT CHRISTOPHER	MARCH 16 2011	COMMISSION MTG	100.00
		29386	TOWNSEND JOHN F III	MARCH 16 2011	COMMISSION MTG	100.00
		32150	WATSON BRETT VON CANNON	MARCH 16 2011	COMMISSION MTG	100.00
					ACCOUNT TOTAL	800.00 *
5230		30439	Telecommunications	816442183 311	PHONE	58.76
			US CELLULAR			58.76 *
5510		12628	Travel-Mileage	MARCH 16 2011	MILEAGE	12.24
		16195	COLEMAN R SAMUEL	MARCH 16 2011	MILEAGE	20.40
		17883	GILLIAM DONALD B	MARCH 16 2011	MILEAGE	20.40
		19875	HUNT PRESTON	MARCH 16 2011	MILEAGE	5.10
		19875	JONES ROBERT M	MARCH 16 2011	MILEAGE	9.18
		22170	MASON ROBERT CHRISTOPHER	MARCH 16 2011	MILEAGE	45.75
		25359	PICKETT JONATHAN	MILEAGE-NOV 10	MILEAGE	7.65
		29386	TOWNSEND JOHN F III	MARCH 16 2011	MILEAGE	120.72 *
					ACCOUNT TOTAL	24.95
6001		11894	Office Supplies	1412 PUCKETT311	CHARGING CORD	24.95 *
			BUSINESS CARD			1,004.43 **
					ACCOUNT TOTAL	24.95 *
					MAJOR TOTAL	1,004.43 **
081500			ECONOMIC DEVELOPMENT			
5210		11894	Postal Services	2078 CARNEY 311	POSTAGE	44.00
			BUSINESS CARD			44.00 *
					ACCOUNT TOTAL	44.00 *
5230		30439	Telecommunications	816442183 311	PHONE	31.13
			US CELLULAR			31.13 *

AP375H
3/31/2011
FUND # - 100 GENERAL FUND

PRINCE EDWARD
LISTING OF INVOICES FOR 3/18/2011 -- 3/31/2011

AFTER CHECKS
PAGE 12

MAJOR# ACCT# 6001	VENDOR NUMBER 11894	VENDOR NAME Office Supplies BUSINESS CARD	INV# 2078 CARNEY 311	DESCRIPTION STORAGE RACK	AMOUNT 193.97 193.97 * 269.10 **
081600	TOURISM				
5110	31846	Electrical Services DOMINION VA POWER	0675198071 311	ELECTRIC SERVICE	172.80
	31846	DOMINION VA POWER	1059387447 311	ELECTRIC SERVICE	40.84
5210	11894	Postal Services BUSINESS CARD	1412 PUCKETT311	UPS CHARGES	213.64 *
5230	10105	Telecommunications AT&T	392 1482 311	PHONE	31.78 *
	22489	MOONSTAR BBS	ECO DEV 311	DSL	63.07
5898	21750	VTC Best part Grant LEISURE PUBLISHING CO	56900	BROCHURE AD	45.00
	999999	O'NEIL RICK	67	AD/BROCHURE/WEB WORK	108.07 *
083500	COOPERATIVE EXTENSION OFFICE				4,950.00
5230	21319	Telecommunications CENTURYLINK	309520098 311	PHONE	1,100.00
091000	GENERAL EXPENSE				6,050.00 *
5804	29937	COBRA Health Insurance ANTHEM BCBS	COBRA 311	COBRA INSURANCE	6,403.49 **
094000	CAPITAL PROJECTS				94.67
0024	11894	Cannery BUSINESS CARD			94.67 *
	22462	MILLS HEATING & AIR			94.67 **
					510.00
					510.00 *
					510.00 **
					4,953.85
					7,641.50
					12,595.35 *
					12,595.35 **
					FUND TOTAL
					213,021.00

AP375H
3/31/2011
FUND # - 501 WATER FUND

PRINCE EDWARD
LISTING OF INVOICES FOR 3/18/2011 -- 3/31/2011

AFTER CHECKS
PAGE 13

MAJOR#	VENDOR NUMBER	VENDOR NAME	INV#	DESCRIPTION	AMOUNT
030000	16671	CONTRACTUAL SERVICES			
		Repairs & Maintenance			
3810	16671	GRAINGER	9476149720	ADAPTER/TEST METER	325.48
				ACCOUNT TOTAL	325.48 *
				MAJOR TOTAL	325.48 **
				FUND TOTAL	325.48

AP375H
3/31/2011
FUND # - 502 SEWER FUND

PRINCE EDWARD
LISTING OF INVOICES FOR 3/18/2011 -- 3/31/2011

AFTER CHECKS
PAGE 14

MAJOR#	VENDOR NUMBER	VENDOR NAME	INV#	DESCRIPTION	AMOUNT
5110	31846	Electrical Services DOMINION VA POWER	4148700281	SEWER PUMP	31.37
				ACCOUNT TOTAL	31.37 *
				MAJOR TOTAL	31.37 **
				FUND TOTAL	31.37

AP375H
3/31/2011
FUND # - 732

RETIREMENT BENEFIT FUND
PRINCE EDWARD
LISTING OF INVOICES FOR 3/18/2011 -- 3/31/2011

AFTER CHECKS
PAGE 15

MAJOR#	VENDOR NUMBER	VENDOR NAME	INV#	DESCRIPTION	AMOUNT
002230	29937	Retirees Insurance ANTHEM BCBS	APRIL 2011	RETIREE HEALTH INS	1,020.00
				ACCOUNT TOTAL	1,020.00 *
				MAJOR TOTAL	1,020.00 **
				FUND TOTAL	1,020.00

AP375H
3/31/2011
FUND # - 740 REVENUE SHARING-VDOT FUND

PRINCE EDWARD
LISTING OF INVOICES FOR 3/18/2011 -- 3/31/2011

AFTER CHECKS
PAGE 16

MAJOR#	VENDOR NUMBER	VENDOR NAME	INV#	DESCRIPTION	AMOUNT
094000	0104	REVENUE SHARING FUND - VDOT			
	17925	Route 628 Alternate HURT & PROFFITT, INC	26641	ALT ROUTE 628	37,459.00
				ACCOUNT TOTAL	37,459.00 *
				MAJOR TOTAL	37,459.00 **
				FUND TOTAL	37,459.00

PIEDMONT COURT SERVICES FUND
PRINCE EDWARD
LISTING OF INVOICES FOR 3/18/2011 -- 3/31/2011

MAJOR#	VENDOR NUMBER	VENDOR NAME	INVT#	DESCRIPTION	AMOUNT
021400	PIEDMONT COURT SERVICES				
5110	31846	Electrical Service	4324962309 311	ELECTRIC SERVICE	103.61
	31846	DOMINION VA POWER	7218131923 311	ELECTRIC SERVICE	141.29
				ACCOUNT TOTAL	244.90 *
5210	25483	Postal Services	6947601 MR11	POSTAGE METER LEASE	202.00
		PITNEY BOWES FINANCL SERV			202.00 *
5230	10105	Telecommunications	392 8161 311	PHONE	132.55
		AT&T			132.55 *
5560	999999	CCJB Meetings	PCCJB MTG 311	MEALS	301.04
		MILDRED'S MEALS			301.04 *
6012	28652	Books & Subscriptions	PCS 310	SUBSCRIPTION	22.00
		SOUTHSIDE MESSENGER			22.00 *
8202	28757	Furniture and Fixtures	PCS DESK CHAIR	DESK CHAIR	229.99
		STAPLES ADVANTAGE			229.99 *
				MAJOR TOTAL	1,132.48 **
097001	PCS SUPERVISION FEES EXPENDITURES				
5420	28724	PCS - Lease/Rent of Build	RENT 311	RENT	2,383.00
		SRP CORPORATION LLC			2,383.00 *
				ACCOUNT TOTAL	2,383.00 **
				MAJOR TOTAL	3,515.48
				FUND TOTAL	255,372.33
				TOTAL DUE	

Approved at meeting of _____ on _____.

Signed _____ Title _____ Date _____

_____ Title _____ Date _____

_____ Title _____ Date _____



**County of Prince Edward
Board of Supervisors
Agenda Summary**

Meeting Date: April 12, 2011
Item No.: 5-d
Department: County Administration
Staff Contact: Sheila Martin/Barbara Poulston
Issue: Consent Agenda - Salaries

Summary: The County Administrator reported that checks have been issued pursuant to the order of the Board of Supervisors as to salaries, etc., the amount of which salaries have been heretofore approved.

Attachments: None.

Recommendation: None.

Motion _____
Second _____

Campbell _____
Jones _____
Wilck _____

Fore _____
McKay _____
Wiley _____

Gantt _____
Simpson _____



County of Prince Edward
Board of Supervisors
Agenda Summary

Meeting Date: April 12, 2011
 Item No.: 5-e
 Department: County Administrator
 Staff Contact: W.W. Bartlett
 Issue: Appropriations and Budget Amendments

Summary:

The first action item accepts and appropriates funds the Circuit Court Clerk will receive from the Technology Trust Fund to pay for annual maintenance of the ILS Indexing system.

The second action item accepts and appropriates funds collected by the Sheriff's department for the purchase of Neighborhood watch signs

Attachments:

Recommendation:

Approve the budget amendment below and appropriate the same funds.

REV/EXP	FUND	DEPT	OBJECT	DESCRIPTION	DEBIT	CREDIT
FY 2011 Budget Amendment						
3(Rev)	100	23000	0080	Technology Trust Funds		\$ 2,557
4(Exp)	100	21600	5880	Clerk of Circuit Court/ TTF	\$ 2,557	
3(Rev)	100	18990	0016	Misc. Revenue-Sheriff's Office		\$ 1,917
4(Exp)	100	31200	6003	Public Education/Crime Prevention	\$ 1,917	

Motion _____
 Second _____

Campbell _____
 Jones _____
 Wilck _____

Fore _____
 McKay _____
 Wiley _____

Gantt _____
 Simpson _____



County of Prince Edward
Board of Supervisors
Agenda Summary

Meeting Date: April 12, 2011
Item No.: 5-f
Department: County Administration
Staff Contact: W.W. Bartlett/Sarah Puckett
Issue: HSC Fireworks Permit

Summary: Attached is the annual letter of request from the HSC Chemistry Department for permission to hold a 4th of July fireworks display.

Attachments: Letter from HSC Chemistry Department

Recommendation: Approval

Motion _____
Second _____

Campbell _____
Jones _____
Wilck _____

Fore _____
McKay _____
Wiley _____

Gantt _____
Simpson _____

HAMPDEN-SYDNEY COLLEGE

HAMPDEN-SYDNEY, VIRGINIA

March 28, 2011

To the Board of Supervisors of Prince Edward County:

The Chemistry Department of Hampden-Sydney College requests permission for a neighborhood fireworks display to be held on July 4, 2011, in the side yard of the W. W. Porterfield residence at 4 Venable Lane on the college campus. Only Class C fireworks will be used, and ignition will be directly supervised by staff members of the chemistry department. The display will be similar to those approved by the Board in previous years.

We would appreciate the return of a signed permission, either as a separate letter or simply noted at the bottom of this page. Thank you for your consideration.



W. W. Porterfield
for the department

Permission is hereby granted for the requested fireworks display on July 4, 2011, as noted above,
by action of the Prince Edward County Board of Supervisors on _____.

Wade Bartlett
County Administrator



County of Prince Edward
Board of Supervisors
Agenda Summary

Meeting Date: April 12, 2011
Item No.: 6
Department: VDOT
Staff Contact: Sarah Elam Puckett
Issue: Highway Matters

Summary: The VDOT monthly update will be in the Table Pack.

Attachments: None.

Recommendation: None.

Motion _____
Second _____

Campbell _____
Jones _____
Wilck _____

Fore _____
McKay _____
Wiley _____

Gantt _____
Simpson _____

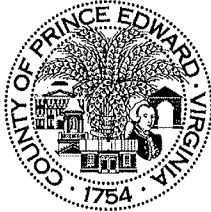

**County of Prince Edward
Board of Supervisors
Agenda Summary**

Meeting Date: April 12, 2011
Item No.: 7
Department: Planning & Community Development
Staff Contact: Alecia Daves-Johnson
Issue: PUBLIC HEARING -- REQUEST FOR REZONING, RICHARD RAYMOND, JR. AND ROBERT RAYMOND, SR.

Summary: A rezoning application has been received from Richard Raymond, Jr. and Robert Raymond, Sr. to rezone from A-2, Agricultural Residential, to C-1, General Commercial, a 1.5 acre parcel located at 4644 Farmville Road, which is at the southern intersection of Stokes Road and Farmville Road, and further described as tax map parcel 50-A-71. The purpose of the request is to permit Automobile Renting /Leasing for a moving truck rental business and General Offices uses to locate on the property. This property is part of the “Corridor Development Area” identified in the County Comprehensive Plan. This Special Policy Area is discussed in Chapter VI and extends along Route 15, “Farmville Road”, from Worsham north to the intersection with Route 628, “Commerce Road”.

The future land use category of “Commercial” on the *Generalized Future Land Use Map of Prince Edward County*, found in the Comprehensive Plan, indicates that this parcel is within a desired location of future commercial development in the county. It also sits in close proximity to a commercial hub indicated on the same map at the Kingsville intersection of Rt 133 and Rt 15.

There are residential properties which could be affected by rezoning this parcel. During two public hearings conducted by the Planning Commission, the primary concerns raised by neighboring property owners were increases in traffic leading to increased hazard along this section of Farmville Road, lighting overspill from the site, and an overall decrease in property values due to the proximity of a commercial site. With well-planned signage, lighting, and landscaping this site could be properly buffered from adjacent non-commercial uses. Following the public comment, the applicants revised their initial site plan – eliminating a used auto sales business in exchange for general offices instead. The applicants also selected a building design which is in keeping with the existing residential vernacular, reducing the commercial feel of the site. According to the applicants, VDOT has provided a preliminary approval for the commercial entrance to the site. The site is anticipated to generate less than a 1% increase in the traffic on Route 15.

Attachments: Public Hearing Notice
 Site Plan & Aerial
 Planning Commission Minutes February 15, 2011 excerpt

Recommendation: At its February 15, 2011 meeting, the Planning Commission recommended approval of a conditional rezoning request by Robert Raymond, Sr. and Richard Raymond, Jr. of property located at 4644 Farmville Road and identified as Tax Map Parcel 50-A-71 from Agricultural Residential to General Commercial for use as General Offices and Auto Rental (for moving truck rental) with the conditions that exterior lighting be limited to downward lighting attached to the building, that a continuous buffer be planted and perpetually maintained along Stokes Road in compliance with the Zoning Ordinance Design Standards, and that the maximum construction height not exceed 40’.

Staff recommends that the Board of Supervisors consider a condition limiting the truck rental business to parking for no more than ten (10) active vehicles at the site, no trucks or trailers that are non-operational could be stored on the site, and that truck repair and maintenance must occur off-site.

Motion _____	Campbell _____	Fore _____	Gantt _____
Second _____	Jones _____	McKay _____	Simpson _____
	Wilck _____	Wiley _____	

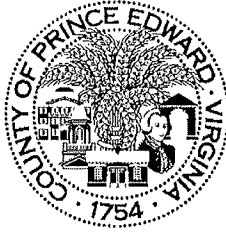

COUNTY OF PRINCE EDWARD, VIRGINIA

WWW.CO.PRINCE-EDWARD.VA.US

March 15, 2011

Please publish in the Friday, March 25, 2011 & Friday, April 1, 2011 editions of *The Farmville Herald*:

PUBLIC HEARING NOTICE

The Prince Edward County Board of Supervisors will hold a public hearing on Tuesday, April 12, 2011 at 7:30 p.m., in the Board of Supervisors Room, 3rd floor, of the Prince Edward County Courthouse, Farmville, Virginia to gather citizen input on the following rezoning request:

Request of Richard Raymond, Jr. and Robert Raymond, Sr. to rezone from A-2, Agricultural Residential, to C-1, General Commercial a 1.5 acre parcel located at 4644 Farmville Road, and further described as Tax Map Parcel # 50-A-71. The purpose of the request is to permit General Offices and Automobile Rental / Leasing (moving truck rental) uses to locate on the property. A copy of the site plan is on display in the Prince Edward County Administrator's Office.

For additional information, please contact the Prince Edward County Administrator's Office at 434-392-8837. It is the County's intention to comply with the requirements of the Americans with Disabilities Act. Should you need special accommodations, please contact the County Administrator's office at 434-392-8837, prior to April 8, 2011.

By Order of Board of Supervisors
Of Prince Edward County, Virginia

W. W. Bartlett, County Administrator

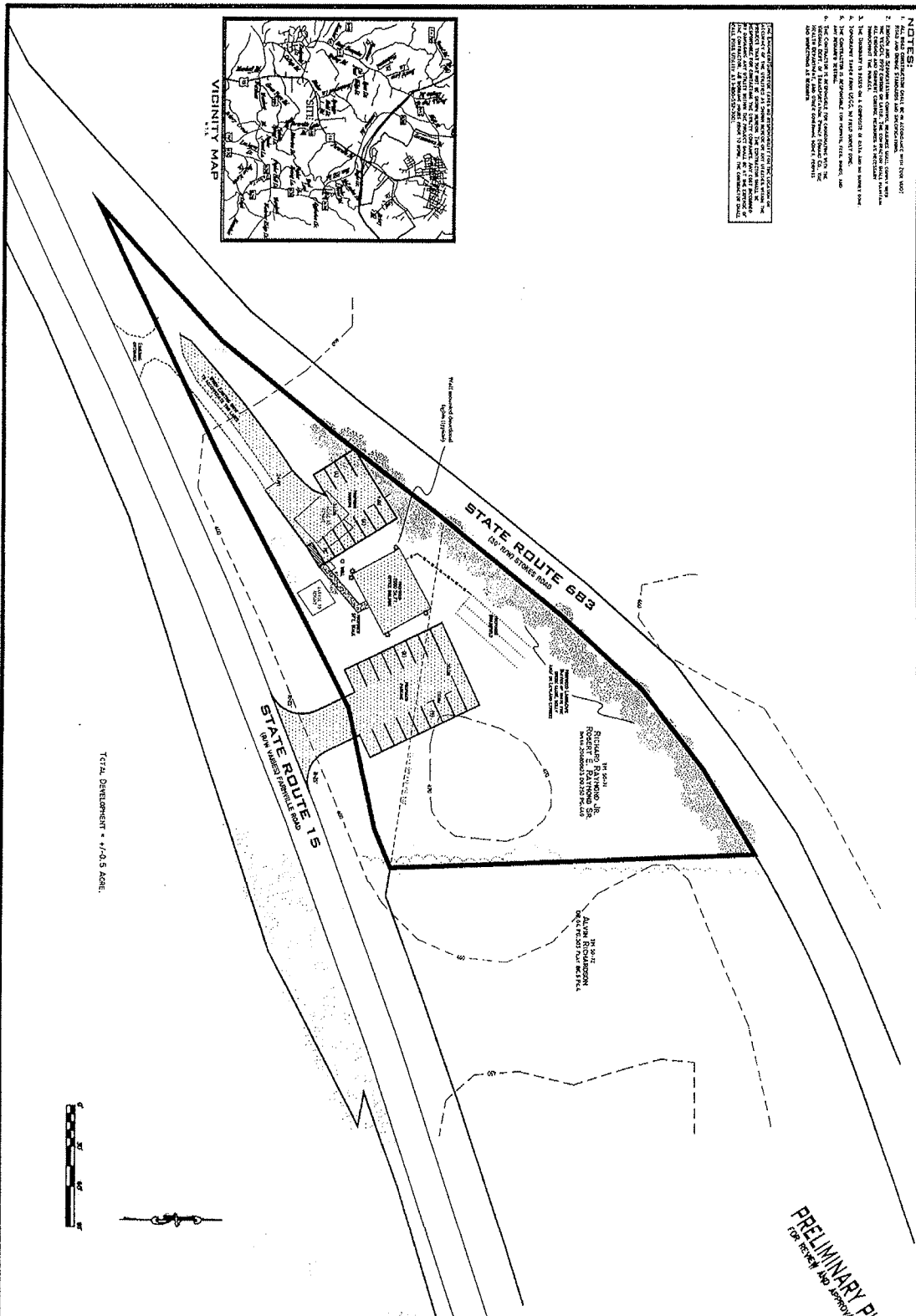

NOTES:

1. THIS CONCEPT PLAN IS FOR INFORMATIONAL PURPOSES ONLY. IT IS NOT TO BE USED FOR ANY OTHER PURPOSE.
2. THE DEVELOPER SHALL BE RESPONSIBLE FOR OBTAINING ALL NECESSARY PERMITS AND APPROVALS FROM THE APPROPRIATE AGENCIES.
3. THE DEVELOPER SHALL BE RESPONSIBLE FOR OBTAINING ALL NECESSARY PERMITS AND APPROVALS FROM THE APPROPRIATE AGENCIES.
4. THE DEVELOPER SHALL BE RESPONSIBLE FOR OBTAINING ALL NECESSARY PERMITS AND APPROVALS FROM THE APPROPRIATE AGENCIES.
5. THE DEVELOPER SHALL BE RESPONSIBLE FOR OBTAINING ALL NECESSARY PERMITS AND APPROVALS FROM THE APPROPRIATE AGENCIES.
6. THE DEVELOPER SHALL BE RESPONSIBLE FOR OBTAINING ALL NECESSARY PERMITS AND APPROVALS FROM THE APPROPRIATE AGENCIES.
7. THE DEVELOPER SHALL BE RESPONSIBLE FOR OBTAINING ALL NECESSARY PERMITS AND APPROVALS FROM THE APPROPRIATE AGENCIES.
8. THE DEVELOPER SHALL BE RESPONSIBLE FOR OBTAINING ALL NECESSARY PERMITS AND APPROVALS FROM THE APPROPRIATE AGENCIES.
9. THE DEVELOPER SHALL BE RESPONSIBLE FOR OBTAINING ALL NECESSARY PERMITS AND APPROVALS FROM THE APPROPRIATE AGENCIES.
10. THE DEVELOPER SHALL BE RESPONSIBLE FOR OBTAINING ALL NECESSARY PERMITS AND APPROVALS FROM THE APPROPRIATE AGENCIES.

Total Development = 47.93 Acre.

PRELIMINARY PLAN
FOR REVIEW AND APPROVAL

SHEET NO. 1 OF 1 SHEET	WATSON & DUGGAN PLC 1001 1/2 Main Street, Farmville, Virginia 22430	NO. DATE	REVISIONS
		CONCEPT PLAN RAYMOND BUSINESS PARK	



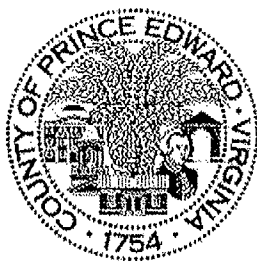

Prince Edward County Planning Commission

Meeting Minutes

February 15, 2011

7:30 pm

Members Present: William Porterfield, Chairman
Chris Mason, Vice Chairman
Sally Gilfillan
Bobby Jones
Jack Leatherwood
John Townsend
Cannon Watson

Members Absent: Donald Gilliam
Sam Coleman

Resignation: Lee Hicks, Jr. (effective Jan 31, 2011)

Staff Present: Alecia Daves-Johnson, Planner, Department of Planning & Community Dev.
Wade Bartlett, County Administrator

The February 15, 2011 meeting was called to order by Chairman Porterfield.

Minutes:

Chairman Porterfield asked for any corrections or additions to the January 18, 2011 minutes. Hearing none, he declared them approved for filing as distributed.

Rezoning Request & Site Plan:

Chairman Porterfield directed attention to the review of the site plan submitted by the Raymonds for the rezoning request for the parcel located at 4644 Farmville Road which the Planning Commission has discussed during the past two meetings. He confirmed that all commissioners had received a copy of the site plan.

Chairman Porterfield called on Ms. Daves-Johnson to discuss how the request had changed since the first submission in December. Ms. Daves-Johnson explained that the site plan presented for review has been changed since the first presentation by the Raymonds. The current site plan does not contain an ingress / egress point from Stokes Road. Also, in response to neighborhood concerns, the request for the use has changed from the Auto Sales, Used car sales use to a General Offices use. The applicant wishes to maintain the Auto Rental use for a moving truck rental business at the site.

Chairman Porterfield reminded that there have already been two public hearings for the proposal, but explained that public comments could be entertained tonight also. He then asked for comments from the Commissioners.

Commissioner Gilfillan directed her question to the Raymonds and asked whether the meeting with the neighborhood had occurred. Mr. Richard Raymond explained that Robert Raymond had met with neighbors at the beginning of the project planning, and that since then the only opposition to the project had been directed toward the used car sales which they have subsequently removed from the project plans.

Chairman Porterfield called on Ms. Daves-Johnson for any public comments received. Ms. Daves-Johnson provided the following comments:

Parcel 50-A-65: Mr. Leslie Stokes, associated with 83 Stokes Rd, remains opposed to the project, even with the General Offices change, because the truck rental portion is retained. He is concerned about the property becoming an eyesore and devaluing his property. Route 15 is a main corridor and it should be an attractive entrance into Farmville and for the homeowners there. "I'm not against change, I know things have to change, but I have personally turned down a cell-tower offer because of my respect for the neighborhood." Call received February 15, 2011 at 9:30a.m.

Parcel 50-2-1: Ms. Evette Farley, landowner at 183 Stokes Rd, called to express her opposition to the project and explained that she does not desire commercial development in her neighborhood. Call received February 15, 2011 at 3:58 p.m.

50-A-78, 50-A-76: Ms. India Redd, landowner on Spraggs-Redd Drive and property along Stokes Road, objects to the rezoning stating that Stokes Road is too narrow for trucks and commercial traffic, there are dangerous intersections already where Stokes Rd and Route 15 intersect and that she is concerned about additional traffic generated by commercial uses.

Letter dated February 9, 2011: Christopher and Brenda Bolding, 289 Stokes Road, expressed opposition to the rezoning request. (Copy of letter filed with minutes.)

Letter not dated: James and Shirley Bolding, 337 Stokes Road, expressed opposition to the rezoning request. (Copy of letter filed with minutes.)

E-mail rec'd February 15, 2011: Hampden-Sydney College via Shirley Robertson, Business Operations Manager, expressing concern about traffic safety and the effect of the site entrance on the college's long term plan to provide a new scenic entrance to the campus. (Copy of e-mail filed with minutes.)

[POST MEETING NOTE: *A letter was received by FAX dated February 15, 2011 from Howard W. and Jane H. Stokes, and staff received the FAX after the PC Meeting. This letter requested rejection of the rezoning application citing reduction of residential values and creating an unsightly appearance as reasons.*]

Commissioner Jones offered a reply to the concern expressed by HSC. He agreed with the safety concerns, but rejected the concern about limiting future commercial entrances due to an entrance planned for the college. He was concerned that many of the emails and phone calls might not have realized that the used auto sales request had been rescinded and that the entrance to Stokes Road had been removed from the site plan.

Chairman Porterfield asked the Raymonds to address whether the existing driveway would be used as a commercial entrance. There will not be a commercial turn-lane at the existing entrance, but it would be widened for use. There is a larger entrance planned for the site.

Chairman Porterfield asked about whether the site plan boundary reflected the right-of-way of Stokes Road and Route 15. Mr. Richard Raymond explained that the site plan was harmonious with the right-of-way, but that the line weight didn't indicate it clearly on the photocopied site plans. Commissioner Gilfillan expressed concern that there be room for the right-of-way, landscape buffer, and set-backs. Mr. Raymond agreed to remove two parking spaces if necessary to meet set-back and right-of-way requirements, including the eight feet (8') wide landscape buffer.

Mr. Raymond explained that the lighting would only be mounted to the corners of the building and pointed downward, and that there would not be any poles or lights in the parking lot areas. Commissioner Mason suggested that a motion detector be used to limit the light emitted throughout the night, and because it could result in energy savings. The Raymonds agreed this was a good idea.

Chairman Porterfield stated that removing the commercial entrance from Stokes Road assured that there would be no traffic impact to Stokes Road from the development of this site, and that the type of businesses proposed would not generate traffic loads which would be problematic for Route 15.

Chairman Porterfield asked whether any members of the audience wished to speak to the Commission. He summarized that a continuous line of fairly rapidly growing vegetation for a landscaped buffer was added, that there would no longer be a used car lot, and there was no entrance from the site to Stokes Road.

Commissioner Townsend called for a rendition of the proposed building for the site and pointed to the allowance of a 60' building height in the Zoning Ordinance for General Commercial parcels. He suggested that a height limitation of 40' be a condition for the rezoning request.

There was much discussion associated with the plan review.

Commissioner Leatherwood asked whether the truck rental would be a commercial rental company. Mr. Arthur Rowley approached the podium and introduced himself as the current owner of the Penske Truck Rental business presently located on 1001 E. Third Street in Farmville. He invited the Commissioners to visit with the residential neighbors behind his business, and explained that since July he has only had four trucks at a time on his lot. The hours of operation are Monday - Friday from 8 a.m. - 5 p.m. and Saturdays 8 a.m. - 12 noon.

Chairman Porterfield asked the dimensions of the parking lot and inquired about the surface treatment plans. Mr. Raymond replied that the surface will be gravel and eventually asphalt. Chairman Porterfield confirmed that if the parking lot is less than 5,000 sf then gravel is acceptable.

Chairman Porterfield called for any additional questions. Hearing none, he made a motion that the Planning Commission recommend favorably to the Board of Supervisors the conditional rezoning of the parcel at 4644 Farmville Road to General Commercial for the purpose of office space and truck rental and that the conditions include downward lighting attached to the building, a continuous buffer planting in compliance with zoning requirements along Stokes Rd, and a maximum construction height not to exceed 40'.

Commissioner Mason inquired about the motion sensing light operation. Chairman Porterfield stated it was a good idea, but did not wish to include it as a condition.

Commissioner Gilfillan expressed interest in hearing from any neighbors along Stokes Rd that were present in the audience in response to the conversation by the Planning Commission.

Ms. Martha Cleveland approached the podium and explained that her family (owners of (50-A-70)) has opposed these plans, especially for the used car lot which has since been removed, although she is still concerned about the "U-Haul trucks". She appreciates that the gentlemen are trying to start a business, and noted that even though there were objections from her and her family, the revisions to the site plan were an improvement. She provided written comments. (A copy is filed with the minutes.)

Gilfillan asked that perpetual maintenance of the landscape buffer be part of the conditions. She requested that the adjacent property owners be sent a letter about the new plan and the opportunity to attend the Public Hearing before the Board of Supervisors.

Mr Richard Raymond interjected that Mr. Robert Raymond had spoken with the neighbors. Ms. Cleveland responded that there was a conversation about changing the lot to an office building but that the used car lot had not been mentioned.

Chairman Porterfield called for a vote on the motion to recommend conditional rezoning of the property with the conditions that exterior lighting be limited to downward lighting attached to the building, that a continuous buffer be planted and perpetually maintained along Stokes Road which complies with the Zoning Ordinance Design Standards, and that the maximum construction height not exceed 40'. The vote was met with unanimous favor.

Commissioner Watson added that the extra traffic on Stokes Road and the used car sales issues which were the most contested by the public were resolved by the new site plan.

<p>RECOMMENDATION TO THE BOARD OF SUPERVISORS: The Planning Commission recommends approval of a conditional rezoning request by Robert Raymond, Sr. and Richard Raymond, Jr. of property located at 4644 Farmville Road and identified as Tax Map Parcel 50-A-71 from Agricultural Residential to General Commercial with the conditions that exterior lighting be limited to downward lighting attached to the building, that a continuous buffer be planted and perpetually maintained along Stokes Road in compliance with the Zoning Ordinance Design Standards, and that the maximum construction height not exceed 40'.</p>
--

Resolution:

The Planning Commission reviewed a Resolution of Respect for Thomas Pairet and a Resolution of Respect for Lee Hicks, Jr. for their service to the Planning Commission. Chairman Porterfield read both resolutions aloud, he called for a vote for each resolution. Each resolution received unanimous favor of the Planning Commissioners.

Agri-tourism Request:

Ms. Daves-Johnson asked if the Planning Commission wished to amend the Agricultural Conservation District (A-1) description in the Zoning Ordinance to include Agri-tourism as a Special Use. She described a phone call inquiry from a lady who is interested in operating a corn-maze in the Prospect area in the Fall. Ms. Daves-Johnson explained a corn-maze as a use within a category described as agri-tourism which is not included in the general agriculture definition because it entails commercial business and an

entertainment component. Ms. Daves-Johnson referenced the Comprehensive Plan goal of promoting agricultural business in the County and suggested that agri-tourism be added as a use in the A-1 District, Zoning Ordinance. Chairman Porterfield stated that Community Recreation is a permitted use in the Agricultural Conservation district and considered this as community recreation, adding that the fact that there will be a charge for it does not change the essential nature of the recreation aspect. There were no objections from the commissioners.

Information Items:

- Capital Improvement Plan: Ms. Daves-Johnson reported that the Emergency Response Providers wish to make a presentation at the March 15th Planning Commission meeting. The Planning Commissioners asked that the Firefighters Association make one presentation representing all of the volunteer fire departments.
- James River Association: The JRA is scheduling evaluations of the County's codes and ordinances to see how well they address nutrient reduction goals for water quality.
- Sub-division Ordinance: Ms. Daves-Johnson suggested that time be scheduled on the March meeting agenda for a work session to review the draft sub-division ordinance. There was discussion and it was agreed upon, if the agenda will allow.

Ms. Daves-Johnson shared an update on Jonathan Pickett which was a report of continued improvement. He is presently trying to establish a consolidation therapy schedule which might prevent him from returning to the office as soon as everyone would like. Commissioner Mason commended Ms. Daves-Johnson for keeping the Planning Commission organized during Mr. Pickett's absence.

Urban Development Area: Chairman Porterfield shared a concern that Prince Edward County would be required to develop an UDA within 18 months due to the census results. This involves planning and zoning for a population growth in the next decade equal to the past decade.

The Planning Commission requests the County Attorney to determine whether there could be an exemption or waiver of Prince Edward's requirement to prepare a UDA if the percentage of population growth in Prince Edward attributed to college students reduced the county population growth below the UDA threshold.

Commissioner Townsend directed everyone's attention to the PlanVirginia website for a detailed presentation about the UDA and TDR programs.

Chairman Porterfield asked for any additional items for business. Hearing none, he thanked everyone for coming and declared the meeting adjourned at 8:40 pm.

Next Meeting: Tuesday, March 15, 2011 at 7:30pm



**County of Prince Edward
Board of Supervisors
Agenda Summary**

Meeting Date: April 12, 2011
Item No.: 8
Department: Board of Supervisors
Staff Contact: Sarah Elam Puckett
Issue: School Board Appointments

Summary: The terms of the following two School Board members expire on June 30, 2010:

- District 201 – Susan Lawman (Supervisor Jones)
- District 601 – Thomas Tillerson (Supervisor Campbell)

At the April Board meeting, the Citizen Committees for Districts 201 and 601 will present to the Board the nominee(s) for School Board for each district.

Attachments: School Board Selection Criteria
List of Citizen Committee Members

Recommendation: Following the presentation of School Board nominees by each Citizen Committee, authorize a Public Hearing for the May Board meeting on the nominees for Districts 201 and 601.

Motion _____ Campbell _____ Fore _____ Gantt _____
Second _____ Jones _____ McKay _____ Simpson _____
Wilck _____ Wiley _____



Adopted: November 13, 1984
Revised: August 10, 2004
Revised: January 13, 2009

CRITERIA FOR SELECTION OF SCHOOL BOARD MEMBERS

1. Each of the eight School Board members shall be appointed by a majority vote of the full Board of Supervisors when the School Board members' terms expire. This vote of the Board of Supervisors shall be by the show of hands.
2. The School Board members' terms of office shall commence on July 1.
3. The criteria for the appointment of School Board members are as follow:
 - a. Each year, the Supervisor from each election district in which a School Board member's term expires shall appoint a three (3) or five (5) member Citizens Committee to review and select candidate(s) for appointment to the School Board.
 - b. The membership of the Citizens Committee shall be announced at the Board of Supervisors meeting in February and published in a newspaper of general circulation, and the voters of the electoral district encouraged to submit nominations to the Chairman of the Committee.
 - c. For the March Board meeting, the County Administrator shall schedule and publish notice of a public hearing at which citizens will have an opportunity to submit names of candidates to be considered for appointment to the School Board. The members of the appointed Citizens Committee shall attend.
 - d. After the public hearing, the Citizens Committee shall interview and seriously consider all persons who are nominated and express willingness to serve, if appointed.
 - e. At the April Board meeting, the Citizens Committee shall report to the full Board of Supervisors a list of candidates for consideration. If the incumbent is requesting reappointment and is the only citizen expressing an interest, the Citizens Committee shall only be required to submit one name, the incumbent's, for consideration. If the incumbent is not requesting reappointment or is ineligible for reappointment, the Citizens Committee shall submit one or more names for consideration. The Citizens Committee shall also provide the Board biographical information on each candidate.
 - f. At the May Board meeting, a public hearing shall be held on the candidate(s) submitted at the April meeting.
 - g. At the June meeting, the Board, by a majority vote, shall appoint one candidate to the School Board.
 - h. The Citizens Committee, in selecting the candidates, shall consider the following:
 1. Person must be an eligible voter and resident of the election district;
 2. Person should be a freeholder;
 3. Person must be willing to serve on the School Board;
 4. Person should have at least a high school education;
 5. Person should be oriented to public service;
 6. Person should be involved, concerned, and dedicated to public education;
 7. Person should be independent (base decisions on factual matters rather than as a representative of a group or faction);
 8. Person should be able to perform the duties and obligations of School Board members;
 9. Person should be of integrity in all matters;
 10. Person should be above prejudice with regard to race, creed, sex, religion, age, and national origin.

###

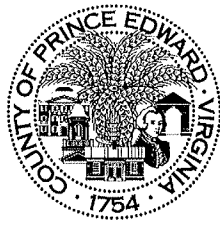

2011 SCHOOL BOARD SELECTION PROCESS CITIZEN COMMITTEES

District 201- Lockett

Richard Stoner, Chair
1174 Holly Farms Road
Rice, Virginia 23966
Phone: 434-392-4795

Joe Bass
1049 Gates-Bass Road
Rice, Virginia 23966
Phone: 434-392-5793

Sonya Walker
456 Piney Grove Road
Rice, Virginia 23966
Phone: 434-547-2940

District 601- Prospect

Kenneth B. Perkins, Chair
Post Office Box 50
Prospect, Virginia 23960
Phone: 434-574-6356

Latrinda Abdus-Sabur
884 Elam Road
Pamplin, Virginia 23958
Phone: 434-574-3440

Dorothy Bruce
Post Office Box 437
Prospect, Virginia 23960
Phone: 434-574-9918



County of Prince Edward
Board of Supervisors
Agenda Summary

Meeting Date: April 12, 2011
Item No.: 9
Department: County Administrator
Staff Contact: Sarah Elam Puckett
Issue: Resolution for 75th Anniversary of Virginia State Parks

Summary: Attached for your consideration is a resolution honoring Virginia State Parks 75th Anniversary.

Attachments: Draft Resolution

Recommendation: Approval

Motion _____
Second _____

Campbell _____
Jones _____
Wilck _____

Fore _____
McKay _____
Wiley _____

Gantt _____
Simpson _____

BOARD OF SUPERVISORS

WILLIAM G. FORE, JR.
CHAIRMAN

HOWARD F. SIMPSON
VICE-CHAIRMAN

HOWARD M. CAMPBELL
DON C. GANTT, JR.
ROBERT M. JONES
CHARLES W. MCKAY
JAMES R. WILCK
MATTIE P. WILEY



COUNTY ADMINISTRATOR
W.W. BARTLETT

POST OFFICE BOX 382
FARMVILLE, VA 23901

(434) 392-8837 VOICE
(434) 392-6683 FAX

WBARTLETT@CO.PRINCE-EDWARD.VA.GOV

COUNTY OF PRINCE EDWARD, VIRGINIA

A RESOLUTION OF THE BOARD OF SUPERVISORS
OF THE COUNTY OF PRINCE EDWARD, VIRGINIA
HONORING THE 75TH ANNIVERSARY
OF VIRGINIA STATE PARKS

WHEREAS, the County of Prince Edward, Virginia is home to three Virginia State Parks – Twin Lakes, High Bridge Trail and Sailor’s Creek Battlefield, more than any other county in the Commonwealth of Virginia; and

WHEREAS, Twin Lakes State Park originally opened in 1950 as Prince Edward State Park for Negroes, was Virginia’s eighth state park and the only pre-Civil Rights Era Park for African-Americans. Nearby Goodwin Lake was a recreational area for local whites. With the end of segregation in 1964, Prince Edward Park and Goodwin Lake staff began working together on large-scale projects. Eventually, the two recreational areas were merged in 1976 and officially became Twin Lakes State Park in 1986; and

WHEREAS, Cedar Crest Conference Center came to fruition in 1991 as a meeting facility at the historic concession, dining and dance hall of Prince Edward State Park. Family reunions, weddings, business meetings, and training classes are conducted year round. Historical displays in the lobby of the conference center, as well as themed rooms and lodgings, offer a glimpse into the site’s history; and

WHEREAS, High Bridge Trail State Park, was established in December 2006, when Norfolk Southern Railway Co. donated a 29.9-mile tract of abandoned railroad to the Commonwealth for the establishment of a new linear state park. The abandoned corridor was part of the Petersburg to Lynchburg rail line. On Aug. 22, 2008, four miles of the park were opened to the public; and

WHEREAS, High Bridge Trail State Park is a multi-use trail ideally suited for hiking, bicycling and horseback riding. The trail’s surface and dimensions make it easy for people of all ages and abilities to enjoy it. Its centerpiece is the majestic High Bridge, which is more than 2,400 feet long and rises 160 above the Appomattox River. The original bridge was built in 1853 as part of the South Side Railroad; and

WHEREAS, Sailor’s Creek Battlefield Historical State Park began with the establishment of the “Sayler’s Creek Battlefield Park Association,” on May 30, 1934; and through their efforts, the 1936 Virginia General Assembly passed a bill appropriating \$1,500.00 for the purchase of land under the direction of the Virginia Conservation Commission. This started with the purchase of the historic Hillsman farm house and ten acres of land at \$150.00 per acre. In partnership with Amelia, Nottoway and Prince Edward Counties, \$1,500.00 was appropriated to restore the structure; and

PRINCE EDWARD COUNTY BOARD OF SUPERVISORS

MISSION STATEMENT

TO REPRESENT ALL CITIZENS, PROVIDE LEADERSHIP, CREATE VISION AND SET POLICY TO ACCOMPLISH EFFECTIVE CHANGE, PLANNED GROWTH AND PROVIDE ESSENTIAL SERVICES WHILE MAINTAINING AND ENHANCING THE QUALITY OF LIFE IN PRINCE EDWARD COUNTY.

WHEREAS, Sailor's Creek Battlefield Historical State Park, with Virginia and National Historical Landmark status, became a stand alone state park in July 2008, and has now expanded to 324.62 acres, with an adjoining 623 acres of land preserved under a conservation easement, and with a renovated Hillsman farm house museum and new visitor center; and

WHEREAS, Virginia was the first state in the nation to develop a park system of six state parks; which were dedicated on June 13 and 14, 1936, with Governor G.C. Perry presiding; and

WHEREAS, Virginia's State Park's have been nationally recognized as the best managed state park systems in the country; and

WHEREAS, Twin Lakes, High Bridge Trail, and Sailor's Creek Battlefield Historical State Parks draws visitors from far and wide, thus contributing to the local economy, and the recreational and educational opportunities for Prince Edward County;

NOW, THEREFORE, BE IT RESOLVED, that the Board of Supervisors of the County of Prince Edward, Virginia hereby congratulates the Virginia State Parks system on the occasion of its 75th Anniversary, and specifically honors our very own Twin Lakes State Park, High Bridge Trail State Park, and Sailor's Creek Battlefield Historical State Park and pledges our support and best wishes for many years to come; and

BE IT FURTHER RESOLVED, that the Board of Supervisors of the County of Prince Edward does hereby designate Saturday June 18, 2011 as "Twin Lakes, High Bridge Trail, and Sailor's Creek Battlefield Historical State Parks Day" in the Count of Prince Edward, Virginia.

Certification

We hereby certify that the foregoing resolution was duly considered by the Board of Supervisors of the County of Prince Edward at a regular meeting in Prince Edward County, Virginia, at which a quorum was present and that same was passed, this 12th day of April, 2011.

William G. Fore, Jr. Chairman

Howard F. Simpson, Vice Chairman

Howard M. Campbell

Don C. Gantt, Jr.

Robert M. Jones

Charles W. McKay

James R. Wilck

Mattie P. Wiley

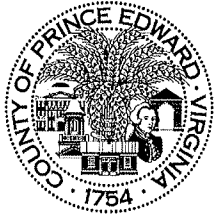

**County of Prince Edward
Board of Supervisors
Agenda Summary**

Meeting Date: April 12, 2011
Item No.: 10
Department: County Administration
Staff Contact: Sarah Elam Puckett
Issue: Citizen Volunteer Appointments

Summary: Listed below is a chart summarizing the boards and commissions which have upcoming vacancies and/or expiring terms of office in June 2011. Also attached is a copy of a Citizen Volunteer Application.

APPOINTMENT	TERM OF OFFICE	# OF VACANCIES	CURRENTLY IN OFFICE
Board of Appeals for Building Code	5 Years	1	Southard Brumfield*
Poplar Hill Community Development Authority	1 Year	2 (Citizen Positions)	Ken Copeland* Joe Eppes*
Poplar Hill Community Development Authority	1 Year	1 (Board Position)	Howard Simpson*
Prince Edward County Industrial Development Authority	4 Years	1	Edgar Jones* L.D. Phaup*
Social Services Board <i>(Position to be filled by resident living in Darlington Heights/ Abileen/ Buffalo District area.)</i>	4 Years	1	Karen Schinabeck
Central Virginia Regional Library Board	4 Years	1	Sandy Heinemann

**Eligible for re-appointment.*

Attachments: Citizen Volunteer Application

Recommendation: Authorize advertising citizen volunteer positions.

Motion _____
 Second _____

Campbell _____
 Jones _____
 Wilck _____

Fore _____
 McKay _____
 Wiley _____

Gantt _____
 Simpson _____



CITIZEN VOLUNTEER APPLICATION FOR COUNTY BOARDS, COMMITTEES & COMMISSIONS

Date _____

Name _____

Home Address _____

City _____ State _____ Zip Code _____

Election District:	Buffalo _____	Farmville 801 _____
	Hampden _____	Leigh _____
	Farmville 101 _____	Lockett _____
	Farmville 701 _____	Prospect _____

Home Telephone Number _____ FAX _____

E-Mail Address _____

Present Employer _____

Business Address _____

City _____ State _____ Zip Code _____

Business Telephone Number _____ FAX _____

Which Address is Preferred for Mailings? Home _____ Office _____

Optional Information Which May Prove Helpful:

Occupation _____

Former Occupation, If Retired _____

Education: High School _____ Year _____

College/Technical School _____ Year _____

Graduate School _____ Year _____

Military Service _____ Years _____

Degrees/Other _____

Past Board, Commission, and Committee Assignments _____

Professional, Civic, or Other Activities _____

Please state below your interest and/or reason to seek appointment by the Board of Supervisors and any special qualities that qualify you for this appointment.

Do you have a family member who is employed by the county office, organization or institution over which the Board/Commission for which you are seeking appointment will oversee/interact? If yes, please explain.

Do you have a business relationship with the county office, organization or institution over which the Board/Commission for which you are seeking appointment will oversee/interact?

I am interested in and willing to serve on the following Board(s), Commission(s), or Committee(s). Please list in order of preference.

APPOINTED BY THE BOARD OF SUPERVISOR:

- _____ Board of Appeals for Building Code
- _____ Southside Virginia Community College Board
- _____ Crossroads Community Services Board
- _____ Poplar Hill Community Development Authority
- _____ Prince Edward County Industrial Development Authority
- _____ Central Virginia Regional Library Board
- _____ Prince Edward County Planning Commission
- _____ Prince Edward County School Board
- _____ Prince Edward County Social Services Board
- _____ Commonwealth Regional Council Committees
- _____ STEPS Board
- _____ Piedmont Regional Jail Board
- _____ Special Committee of the Board of Supervisors: _____
- _____ Other(s) _____

APPOINTED BY CIRCUIT COURT:

- _____ Electoral Board
- _____ Board of Zoning Appeals

By submitting this application to the County of Prince Edward, I hereby certify that all information contained herein is true and complete and I consent to the dissemination of this document to the general public.

Signature Date

Please Return Application To:
Prince Edward County Administrator's Office
Post Office Box 382
111 South Street, 3rd Floor
Farmville, Virginia 23901
Tel: 434-392-8837 -- FAX: 434-392-6683
e-mail: info@co.prince-edward.va.us

NOTE: This application will be retained on file in the Prince Edward County Administrator's Office through December 31 of the year submitted. If you wish to be considered for future appointments by the Board of Supervisors, please file an application annually with the County Administrator's Office. Thank you.

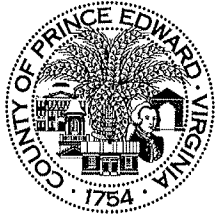

**County of Prince Edward
Board of Supervisors
Agenda Summary**

Meeting Date: April 12, 2011
Item No.: 11
Department: Planning & Community Development
Staff Contact: Alecia M. Daves-Johnson
Issue: Planning Department Report

Summary:

At the April 26, 2011 Planning Commission meeting, the Planning Commission will hold a Public Hearing to consider amendments to the County Zoning Ordinance. These amendments were requested by motion of the Planning Commission at the March 15, 2011 meeting. If approved, this could come before the Board of Supervisors at the June 8, 2011 meeting. (There will not be enough time to provide adequate public notice between the April 26th meeting and the Board's May 10th meeting.)

There is a draft of the proposed language attached with this report. There are three definitions being considered for addition to the Zoning Ordinance: Children's Residential Facility which would permit facilities such as an orphanage, Truck Yard, and the addition of Aquaculture to the existing Agriculture definition. Any definitions added to the Zoning Ordinance also require Use Classification. The proposed Use Classifications are explained in the attached report.

Attachments: Draft Planning Commission Study of Amendment to Zoning Ordinance

Recommendation: Informational only. No action is necessary at this time.

Motion _____
Second _____

Campbell _____
Jones _____
Wilck _____

Fore _____
McKay _____
Wiley _____

Gantt _____
Simpson _____

Establish a definition and use classification for
“Children’s Residential Facility” and “Truck Yard”

I. Children’s Residential Facility

A. Definition:

"Children's residential facility" means any facility, child-caring institution, orphanage, or group home that is maintained for the purpose of receiving children separated from their parents or guardians for full-time care, maintenance, protection and guidance, or for the purpose of providing independent living services to persons between 18 and 21 years of age who are in the process of transitioning out of foster care. Children's residential facility shall not include:

1. A licensed or accredited educational institution whose pupils, in the ordinary course of events, return annually to the homes of their parents or guardians for not less than two months of summer vacation;
2. An establishment required to be licensed as a summer camp; and
3. A licensed or accredited hospital legally maintained as such.

"Summer camp" means and includes any building, tent, or vehicle, or group of buildings, tents, or vehicles, if operated as one place or establishment, or any other place or establishment, public or private, together with the land and waters adjacent thereto, which is operated or used for the entertainment, education, recreation, religious instruction or activities, physical education, or health of persons under eighteen years of age who are not related to the operator of such place or establishment, if twelve or more such persons at any one time are accommodated, gratuitously or for compensation, overnight and during any portion of more than two consecutive days.

B. Use Classification:

Allow as a Residential Use Type by Special Use Permit in A1 (Agricultural Conservation), A2 (Agricultural Residential), R1 (Residential Low Density), R2 (General Residential), R3 (Medium Density Residential), VC (Village Center) and C1 (General Commercial) Districts.

II. Truck Yard

A. Definition

“Truck Yard” is a structure or land used or intended to be used primarily to accommodate the parking or storage of trucks, truck trailers, or truck tractors in active use. A truck yard may include, as incidental uses only, facilities for the service or repair of vehicles.

B. Use Classification

Allow as Industrial Use Type by Special Use Permit in C1 (General Commercial) and I1 (General Industrial) districts, with Use and Design Standards as described below.

C. Use & Design Standards

Truck Terminal and Truck Yard Facilities.

General Standards:

1. To provide for the safe and orderly use of land for parking, servicing, repairing or storage of trucks in active use in a manner that minimizes adverse environmental impacts of such a use upon the surrounding area.
2. The site design shall mitigate existing and potential noise, dust, fumes, traffic, and other adverse environmental impacts affecting neighboring residential and commercial areas. Techniques may include, but are not limited to, walls, fences, buffer zones, landscaping and other mitigating measures.
3. Factors such as adequate paving, striping of truck parking stalls, adequate site drainage, and lighting should be used to ensure safe operation of the facility.
4. The site shall, to the extent reasonably feasible, be located so as to provide for direct vehicular ingress and egress to a primary public route.
5. All habitable structures shall be placed on a permanent foundation.
6. Nothing contained herein shall be deemed to authorize or permit the storage of hazardous materials, substances or wastes which are capable of posing an unreasonable risk to health, safety, or property.
7. Trucks and permitted storage shall not be stored within five (5) feet of any required screening wall.
8. Truck parking and permitted storage shall be arranged in parallel rows and shall be striped.
9. Set backs...
10. Landscape requirements...

III. Aquaculture

- A. Amend the existing definition of "Agriculture" to include *aquaculture activities*.

Ex. AGRICULTURE - The use of land for the production of food and fiber, including farming, dairying, pasturage, agriculture, horticulture, viticulture, *aquaculture activities*, and animal and poultry husbandry. A garden accessory to a residence shall not be considered agriculture. The keeping of a cow, pig, sheep, goat, chicken or similar animal shall constitute agriculture regardless of the size of the animal and regardless of the purpose for which it is kept.

- B. Use Classification

The aquaculture addition would not alter the existing use classification for Agriculture.

- C. Aquaculture Defined:

"Aquaculture" means the cultivation, production, and raising of the natural products of water or activities related to the hatchery, nursery, and maintenance of the product, including tanks, settling facilities, wet storage areas of containers, culture containers, intake and discharge structures, or activities related to the cultivation and maintenance of algae or other feed stocks.

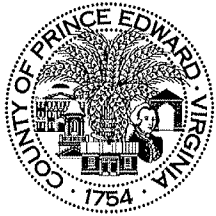

County of Prince Edward
Board of Supervisors
Agenda Summary

Meeting Date: April 12, 2011
Item No.: 12
Department: County Attorney
Staff Contact: James R. Ennis
Issue: County Attorney's Report

Summary: County Attorney Jim Ennis will update the Board on the County Redistricting process.

Attachments:

Recommendation: Approval.

Motion _____
Second _____

Campbell _____
Jones _____
Wilck _____

Fore _____
McKay _____
Wiley _____

Gantt _____
Simpson _____



**County of Prince Edward
Board of Supervisors
Agenda Summary**

Meeting Date: April 12, 2011
Item No.: 13
Department: County Administration
Staff Contact: W.W. Bartlett
Issue: County Administrator's Report

Summary: The County Administrator will discuss with the Board the following items:

- 1. Renewal of County Health Insurance
- 2. County representatives to attend the R.R. Moton Gala Reception

Attachments: Proposed 2011 Rates for 2011 for Prince Edward County
2011 Comparison of Statewide Plans for The Local Choice

Letter from R.R. Moton Museum

Recommendation: To be determined.

Motion _____ Campbell _____ Fore _____ Gantt _____
Second _____ Jones _____ McKay _____ Simpson _____
Wilck _____ Wiley _____

The Local Choice Health Benefits Program

Prince Edward County

Proposed Rates Effective from
July 1, 2011 through June 30, 2012

	<u>Single</u>	<u>Dual</u>	<u>Family</u>
<u>ACTIVE EMPLOYEES</u>			
* Key Advantage Expanded	\$530	\$981	\$1,431
* Key Advantage 250	\$491	\$908	\$1,326
Key Advantage 500	\$454	\$840	\$1,226
Key Advantage 1000	\$427	\$790	\$1,153
High Deductible Health Plan	\$377	\$698	\$1,019
<u>RETIREEES NOT ELIGIBLE FOR MEDICARE</u>			
* Key Advantage Expanded	\$1,060	\$1,961	\$2,862
* Key Advantage 250	\$982	\$1,817	\$2,651
Key Advantage 500	\$908	\$1,680	\$2,452
Key Advantage 1000	\$854	\$1,580	\$2,306
High Deductible Health Plan	\$755	\$1,397	\$2,039
<u>RETIREEES WITH MEDICARE</u>			
* Advantage 65	\$160		
Advantage 65 and Dental/Vision	\$190		

* Benefit Plans Currently Offered

Coverage under The Local Choice Key Advantage and HDHP contracts is for:

- Active Employees and their Dependents
- Retirees not eligible for Medicare and their Dependents not eligible for Medicare, and/or
- Dependents of Medicare eligible Retirees who are not Medicare eligible.

If coverage is offered to Medicare eligible retirees and their Medicare eligible Dependents, it must be obtained through one of our Medicare Supplemental contracts which require participation in both Parts A and B of Medicare to receive maximum benefits.

Comparison of Statewide Plans 2011

Effective July 1, 2011 or October 1, 2011



The Local Choice 2011 Comparison of Statewide Plans

	Key Advantage Expanded			Key Advantage 250		
Plan year deductible (Key Advantage: applies to certain medical services as indicated on chart)	In-Network:			In-Network:		
	One Person	Two People	Family	One Person	Two People	Family
	\$100	See Family	\$200	\$250	See Family	\$500
(HDHP: applies to medical, behavioral health, and prescription drug services)	Out-of-Network:			Out-of-Network:		
	\$200	See Family	\$400	\$500	See Family	\$1,000
Out-of-pocket expense limit	In-Network:			In-Network:		
	One Person	Two People	Family	One Person	Two People	Family
	\$1,000	See Family	\$2,000	\$2,000	See Family	\$4,000
	Out-of-Network:			Out-of-Network:		
	\$2,000	See Family	\$4,000	\$4,000	See Family	\$8,000
Out-of-network benefits	Yes. Once you meet the out-of-network deductible, you pay 30% coinsurance for medical and behavioral health services. Copayments do not apply to medical and behavioral health services.			Yes. Once you meet the out-of-network deductible, you pay 30% coinsurance for medical and behavioral health services. Copayments do not apply to medical and behavioral health services.		
Medical care when traveling	Included			Included		
Lifetime maximum	Unlimited			Unlimited		
Covered Services	In-Network You Pay			In-Network You Pay		
Ambulance travel	20% coinsurance after deductible			20% coinsurance after deductible		
Behavioral health and EAP						
<i>Inpatient treatment</i>						
• Facility services	\$200 copayment per stay			\$300 copayment per stay		
• Professional provider services	\$0			\$0		
<i>Outpatient professional provider visits</i>	\$15 copayment			\$20 copayment		
Employee Assistance Program (EAP) (up to 4 visits per incident)	\$0			\$0		
Dental	One Person	Two People	Family	One Person	Two People	Family
<i>Dental plan year deductible</i>	\$25	\$50	\$75	\$25	\$50	\$75
<i>Plan year maximum (except Orthodontics)</i>	\$1,500			\$1,200		
<i>Diagnostic and preventive services</i>	\$0, no deductible			\$0, no deductible		
<i>Primary services</i>	20% coinsurance after dental deductible			20% coinsurance after dental deductible		
<i>Complex restorative services</i>	50% coinsurance after dental deductible			50% coinsurance after dental deductible		
<i>Orthodontic services</i>	50% coinsurance, no dental deductible, with \$1,500 lifetime maximum			50% coinsurance, no dental deductible, with \$1,200 lifetime maximum		
Diagnostic tests and x-rays (for specific conditions or diseases at a doctor's office, emergency room or outpatient hospital department)	10% coinsurance, no deductible			10% coinsurance after deductible		
Doctor visits - on an outpatient basis						
<i>Primary care physicians</i>	\$15 copayment			\$20 copayment		
<i>Specialty care providers</i>	\$25 copayment			\$35 copayment		
Emergency room visits						
<i>Facility services</i>	\$100 copayment per visit (waived if admitted)			\$150 copayment per visit (waived if admitted)		
<i>Professional provider services</i>						
• Primary care physicians	\$15 copayment			\$20 copayment		
• Specialty care providers	\$25 copayment			\$35 copayment		
<i>Diagnostic tests and x-rays</i>	10% coinsurance, no deductible			10% coinsurance after deductible		
Home health services (90 visit plan year limit)	\$0			\$0		
Home private duty nurse's services	20% coinsurance after deductible			20% coinsurance after deductible		
Hospice care services	\$0			\$0		

My Advantage 500	Key Advantage 1000	High Deductible Health Plan
------------------	--------------------	-----------------------------

In-Network: One Person Two People Family \$500 <i>See Family</i> \$1,000 Out-of-Network: \$1,000 <i>See Family</i> \$2,000	In-Network: One Person Two People Family \$1,000 <i>See Family</i> \$2,000 Out-of-Network: \$2,000 <i>See Family</i> \$4,000	One Person Two People Family \$1,500 <i>See Family</i> \$3,000
--	--	---

In-Network: One Person Two People Family \$3,000 <i>See Family</i> \$6,000 Out-of-Network: \$6,000 <i>See Family</i> \$12,000	In-Network: One Person Two People Family \$4,000 <i>See Family</i> \$8,000 Out-of-Network: \$8,000 <i>See Family</i> \$16,000	One Person Two People Family \$5,000 <i>See Family</i> \$10,000
---	---	--

Yes. Once you meet the out-of-network deductible, you pay 30% coinsurance for medical and behavioral health services. Copayments do not apply to medical and behavioral health services.	Yes. Once you meet the out-of-network deductible, you pay 30% coinsurance for medical and behavioral health services. Copayments do not apply to medical and behavioral health services.	No coverage, except in emergency.
--	--	-----------------------------------

Included	Included	Included
Unlimited	Unlimited	Unlimited

In-Network You Pay	In-Network You Pay	In-Network You Pay
--------------------	--------------------	--------------------

20% coinsurance after deductible	20% coinsurance after deductible	20% coinsurance after deductible
----------------------------------	----------------------------------	----------------------------------

20% coinsurance per stay after deductible \$25 copayment \$0	20% coinsurance per stay after deductible \$0 \$25 copayment \$0	20% coinsurance after deductible 20% coinsurance after deductible 20% coinsurance after deductible \$0
--	---	---

One Person Two People Family \$25 \$50 \$75 \$1,200 \$0, no deductible 20% coinsurance after dental deductible 50% coinsurance after dental deductible 50% coinsurance, no dental deductible, with \$1,200 lifetime maximum	One Person Two People Family \$25 \$50 \$75 \$1,200 \$0, no deductible 20% coinsurance after dental deductible 50% coinsurance after dental deductible 50% coinsurance, no dental deductible, with \$1,200 lifetime maximum	One Person Two People Family \$25 \$50 \$75 \$1,500 \$0, no deductible 20% coinsurance after dental deductible 50% coinsurance after dental deductible 50% coinsurance, no dental deductible, with \$1,500 lifetime maximum
20% coinsurance after deductible	20% coinsurance after deductible	20% coinsurance after deductible

\$25 copayment \$40 copayment	\$25 copayment \$40 copayment	20% coinsurance after deductible 20% coinsurance after deductible
----------------------------------	----------------------------------	--

20% coinsurance after deductible	20% coinsurance after deductible	20% coinsurance after deductible
----------------------------------	----------------------------------	----------------------------------

\$25 copayment \$40 copayment 20% coinsurance after deductible	\$25 copayment \$40 copayment 20% coinsurance after deductible	20% coinsurance after deductible 20% coinsurance after deductible 20% coinsurance after deductible
--	--	--

\$0	\$0	20% coinsurance after deductible
-----	-----	----------------------------------

20% coinsurance after deductible	20% coinsurance after deductible	20% coinsurance after deductible
----------------------------------	----------------------------------	----------------------------------

\$0	\$0	20% coinsurance after deductible
-----	-----	----------------------------------

The Local Choice 2011 Comparison of Statewide Plans (continued)

Covered Services	Key Advantage Expanded In-Network You Pay	Key Advantage 250 In-Network You Pay
Hospital services		
<i>Inpatient treatment:</i>		
• Facility services	\$200 copayment per stay	\$300 copayment per stay
• Professional provider services		
- Primary care physicians	\$0	\$0
- Specialty care providers	\$0	\$0
<i>Outpatient treatment</i>		
• Facility services	\$100 copayment	\$150 copayment
• Professional provider services		
- Primary care physicians	\$15 copayment	\$20 copayment
- Specialty care providers	\$25 copayment	\$35 copayment
• Diagnostic tests and x-rays	10% coinsurance, no deductible	10% coinsurance after deductible
Infusion services		
<i>Facility services</i>	10% coinsurance after deductible	10% coinsurance after deductible
<i>Professional provider services</i>	10% coinsurance after deductible	10% coinsurance after deductible
<i>Home services</i>	10% coinsurance after deductible	10% coinsurance after deductible
<i>Infusion medications -</i>		
• Outpatient settings	10% coinsurance after deductible	10% coinsurance after deductible
• Home settings	10% coinsurance after deductible	10% coinsurance after deductible
Maternity		
<i>Professional provider services (prenatal & postnatal care)</i>		
• Primary care physicians	\$15 copayment	\$20 copayment
• Specialty care providers	\$25 copayment	\$35 copayment
	If your doctor submits one bill for delivery, prenatal and postnatal care services, there is no copayment required for physician care. If your doctor bills for these services separately, your payment responsibility will be determined by the services received.	
<i>Delivery</i>		
• Primary care physicians	\$0	\$0
• Specialty care providers	\$0	\$0
<i>Hospital services for delivery (delivery room, anesthesia, routine nursing care for newborn)</i>	\$200 copayment per stay*	\$300 copayment per stay*
<i>Outpatient diagnostic tests</i>	10% coinsurance, no deductible	10% coinsurance after deductible
Medical equipment, appliances, formulas and supplies	20% coinsurance after deductible	20% coinsurance after deductible
Outpatient prescription drugs - mandatory generic		
<i>Retail up to 34-day supply*</i>		
	Tier 1 - \$10 copayment	Tier 1 - \$10 copayment
	Tier 2 - \$20 copayment	Tier 2 - \$20 copayment
	Tier 3 - \$35 copayment	Tier 3 - \$35 copayment
*You may purchase up to a 90-day supply at a retail pharmacy by paying multiple copayments, or the coinsurance after the deductible		
<i>Mail Service up to 90-day supply</i>		
	Tier 1 - \$20 copayment	Tier 1 - \$20 copayment
	Tier 2 - \$40 copayment	Tier 2 - \$40 copayment
	Tier 3 - \$70 copayment	Tier 3 - \$70 copayment
Routine vision - Blue View Vision Network (once every 12 months)		
<i>Routine eye exam</i>	\$25 copayment	\$35 copayment
<i>Eyeglass lenses</i>	\$20 copayment	\$20 copayment
<i>Eyeglass frames</i>	Up to \$100 retail allowance**	Up to \$100 retail allowance**
<i>Contact lenses (in lieu of eyeglass lenses)</i>		
• Elective	Up to \$100 retail allowance	Up to \$100 retail allowance
• Non-Elective	Up to \$250 retail allowance	Up to \$250 retail allowance
<i>Lens Options</i>		
• UV coating, tints, standard scratch-resistant	\$15	\$15
• Standard polycarbonate	\$40	\$40
• Standard progressive	\$65	\$65
• Standard anti-reflective	\$45	\$45
• Other add-ons	20% off retail	20% off retail

*This plan will waive the hospital copayment if the member enrolls in the maternity management pre-natal program within the first trimester of pregnancy, has a dental cleaning during pregnancy and satisfactorily completes the program.

**You may select a frame greater than the covered allowance and receive a 20% discount for any additional cost over the allowance.

Key Advantage 500 In-Network You Pay	Key Advantage 1000 In-Network You Pay	High Deductible Health Plan In-Network You Pay
20% coinsurance per stay after deductible	20% coinsurance per stay after deductible	20% coinsurance after deductible
\$0	\$0	20% coinsurance after deductible
\$0	\$0	20% coinsurance after deductible
20% coinsurance after deductible	20% coinsurance after deductible	20% coinsurance after deductible
\$25 copayment	\$25 copayment	20% coinsurance after deductible
\$40 copayment	\$40 copayment	20% coinsurance after deductible
20% coinsurance after deductible	20% coinsurance after deductible	20% coinsurance after deductible
20% coinsurance after deductible	20% coinsurance after deductible	20% coinsurance after deductible
20% coinsurance after deductible	20% coinsurance after deductible	20% coinsurance after deductible
20% coinsurance after deductible	20% coinsurance after deductible	20% coinsurance after deductible
20% coinsurance after deductible	20% coinsurance after deductible	20% coinsurance after deductible
20% coinsurance after deductible	20% coinsurance after deductible	20% coinsurance after deductible
\$25 copayment	\$25 copayment	20% coinsurance after deductible
\$40 copayment	\$40 copayment	20% coinsurance after deductible
If your doctor submits one bill for delivery, prenatal and postnatal care services, there is no copayment required for physician care. If your doctor bills for these services separately, your payment responsibility will be determined by the services received.		
\$0	\$0	20% coinsurance after deductible
\$0	\$0	20% coinsurance after deductible
20% coinsurance per stay after deductible	20% coinsurance per stay after deductible	20% coinsurance after deductible
20% coinsurance after deductible	20% coinsurance after deductible	20% coinsurance after deductible
20% coinsurance after deductible	20% coinsurance after deductible	20% coinsurance after deductible
Tier 1 - \$10 copayment	Tier 1 - \$10 copayment	20% coinsurance after deductible
Tier 2 - \$20 copayment	Tier 2 - \$20 copayment	
Tier 3 - \$35 copayment	Tier 3 - \$35 copayment	
Tier 1 - \$20 copayment	Tier 1 - \$20 copayment	20% coinsurance after deductible
Tier 2 - \$40 copayment	Tier 2 - \$40 copayment	
Tier 3 - \$70 copayment	Tier 3 - \$70 copayment	
\$40 copayment	\$40 copayment	Not covered
\$20 copayment	\$20 copayment	Not covered
Up to \$100 retail allowance**	Up to \$100 retail allowance**	Not covered
Up to \$100 retail allowance	Up to \$100 retail allowance	Not covered
Up to \$250 retail allowance	Up to \$250 retail allowance	Not covered
\$15	\$15	Not covered
\$40	\$40	Not covered
\$65	\$65	Not covered
\$45	\$45	Not covered
20% off retail	20% off retail	Not covered

The Local Choice 2011 Comparison of Statewide Plans (continued)

Covered Services	Key Advantage Expanded In-Network You Pay	Key Advantage 250 In-Network You Pay
Shots - allergy & therapeutic injections (at doctor's office, emergency room or outpatient hospital department)	10% coinsurance, no deductible	10% coinsurance after deductible
Skilled nursing facility stays (180-day per stay limit)		
<i>Facility services</i>	\$0	\$0
<i>Professional provider services</i>	\$0	\$0
Spinal manipulations and other manual medical interventions (30 visits per plan year limit)		
<i>Primary care physicians</i>	\$15 copayment	\$20 copayment
<i>Specialty care providers</i>	\$25 copayment	\$35 copayment
Surgery - see Hospital services		
Therapy services <i>Cardiac Rehabilitation therapy, Chemotherapy, Radiation therapy, Respiratory therapy, Occupational therapy, Physical therapy, and Speech therapy</i>		
<i>Facility services</i>	10% coinsurance after deductible	10% coinsurance after deductible
<i>Professional provider services</i>		
• Primary care physicians	10% coinsurance after deductible	10% coinsurance after deductible
• Specialty care providers	10% coinsurance after deductible	10% coinsurance after deductible
Wellness services <i>Well child (office visits at specified intervals through age 6)</i>		
• Primary care physicians;	No copayment, coinsurance, or deductible	No copayment, coinsurance, or deductible
• Specialty care providers;		
• Immunizations and screening tests		
<i>Routine wellness - age 7 & older</i>		
• Annual check-up visit (one per plan year)	No copayment, coinsurance, or deductible	No copayment, coinsurance, or deductible
- Primary care physicians		
- Specialty care providers		
- Immunizations, lab and x-ray services		
• Routine screenings, immunizations, lab and x-ray services (outside of Annual check-up visit)	No copayment, coinsurance, or deductible	No copayment, coinsurance, or deductible
<i>Preventive care (one of each per plan year)</i>	No copayment, coinsurance, or deductible	No copayment, coinsurance, or deductible
• Gynecological exam		
• Pap test		
• Mammography screening		
• Prostate exam (digital rectal exam)		
• Prostate specific antigen test		
• Colorectal cancer screenings		

y Advantage 500 In-Network You Pay	Key Advantage 1000 In-Network You Pay	High Deductible Health Plan In-Network You Pay
20% coinsurance after deductible	20% coinsurance after deductible	20% coinsurance after deductible
\$0	\$0	20% coinsurance after deductible
\$0	\$0	20% coinsurance after deductible
\$25 copayment \$40 copayment	\$25 copayment \$40 copayment	20% coinsurance after deductible 20% coinsurance after deductible
20% coinsurance after deductible	20% coinsurance after deductible	20% coinsurance after deductible
20% coinsurance after deductible coinsurance after deductible	20% coinsurance after deductible 20% coinsurance after deductible	20% coinsurance after deductible 20% coinsurance after deductible
No copayment, coinsurance, or deductible	No copayment, coinsurance, or deductible	No copayment, coinsurance, or deductible
No copayment, coinsurance, or deductible	No copayment, coinsurance, or deductible	No copayment, coinsurance, or deductible
No copayment, coinsurance, or deductible	No copayment, coinsurance, or deductible	No copayment, coinsurance, or deductible
No copayment, coinsurance, or deductible	No copayment, coinsurance, or deductible	No copayment, coinsurance, or deductible



Tuesday, March 29, 2011

Dear Mr. Wade Bartlett,

On April 22, 2011 the Robert Russa Moton Board of Directors will honor the plaintiffs who signed the petition filed on May 23, 1951 in the Davis v. Prince Edward County Board case and the donors who have made the current construction possible. Your donations have made it possible to transform the Robert Russa Moton High School into the Robert Russa Moton Museum, a center for the Study of Civil Rights in Education. A Gala Reception will be held at the Museum from 6:00pm to 9:00pm.

On behalf of the museum director, Lacy Ward, Jr., I would like to extend a special invitation to the county of Prince Edward to send two representatives to attend this gala as honored guests.

Please reply by email or phone no later than April 15, 2011 to let us know the names of the two individuals who will represent Prince Edward County at this event. If you have any questions, or to RSVP, please contact me at (434) 315-8775, ext. 3 or patrice.carter@motonmuseum.org.

We greatly appreciate your significant contributions and look forward to you celebrating with us on April 22nd.

Sincerely,

Patrice Carter
Program Coordinator



**County of Prince Edward
Board of Supervisors
Agenda Summary**

Meeting Date: April 12, 2011
Item No.: 14
Department: Board of Supervisors
Staff Contact: W.W. Bartlett
Issue: Committee Reports

Summary:

The Memorial Committee (Vice-Chairman Simpson, Supervisor Campbell) met on April 7, 2011 and is finalizing plans and recommendations. The Committee will provide an update to the Board on the planning of the Law Enforcement/Fire/Rescue/Public Service Memorial at the May Board meeting.

The Personnel Committee (Vice-Chairman Simpson, Supervisor Campbell, Supervisor Wilck and Supervisor Wiley) met on April 7, 2011. The Committee brings the following two recommendations to the Board:

1. The Committee concurs with the County Administrator's recommendation that a 3% bonus for County Employees should be included in the FY 12 County Budget. The Committee recommends that the bonus be administered, as follows:
 - a. A 3% bonus be awarded to all full-time county employees, employed prior to July 1, 2011, based on their salary, up to \$50,000;
 - b. A 3% bonus be awarded to all part-time county employees, employed prior to July 1, 2011, based on the employees four-month average salary earned between July 1 and October 30, 2011; and
 - c. The maximum bonus is \$1500; the minimum bonus is \$100.

2. The Committee recommends that the County Personnel Policy be amended to clarify that the Board of Supervisors has the exclusive authority to award county-funded salary increases for full-time or part-time employees.

Attachments: None.

Recommendation: Approval.

Motion _____
Second _____

Campbell _____
Jones _____
Wilck _____

Fore _____
McKay _____
Wiley _____

Gantt _____
Simpson _____



County of Prince Edward
Board of Supervisors
Agenda Summary

Meeting Date: April 12, 2011
Item No.: 15
Department: County Administration
Staff Contact: W.W. Bartlett/Sarah Puckett
Issue: Correspondence

Summary:

Attachments:

- a. Citizen E-mail, RE: Thank You to Planning Department

Recommendation: None.

Motion _____
Second _____

Campbell _____
Jones _____
Wilck _____

Fore _____
McKay _____
Wiley _____

Gantt _____
Simpson _____

Sarah Puckett

From: Sarah Puckett [spuckett@co.prince-edward.va.us]
Sent: Monday, April 04, 2011 8:09 AM
To: spuckett@co.prince-edward.va.us
Subject: FW: Thank you!

From: richard raymond [mailto:raymondins@gmail.com]
Sent: Wednesday, February 16, 2011 1:47 PM
To: Alecia Daves-Johnson
Subject: Thank you!

Alecia,

Just wanted to say thank you for all your help over the past few months?
You've been a really big help to Bob & I and we really do appreciate it!
Hope everything is going well!
See you soon.

Rick

--
Richard Raymond Jr.
Raymond Insurance Agency
1001 East Third Street Suite 2
Farmville, Virginia 23901
(434)392-8911
(434)392-8906 fax
(434)392-1010 cell



County of Prince Edward
Board of Supervisors
Agenda Summary

Meeting Date: April 12, 2011
Item No.: 16
Department: County Administration
Staff Contact: W.W. Bartlett/Sarah Puckett
Issue: Monthly Reports

Summary:

Attachments:

- a. Animal Control
- b. Building Official
- c. Cannery
- d. Prince Edward County Public Schools
- e. PERT
- f. Tourism

Recommendation: Acceptance.

Motion _____
Second _____

Campbell _____
Jones _____
Wilck _____

Fore _____
McKay _____
Wiley _____

Gantt _____
Simpson _____



Animal Control Monthly Report

"March 2011"

Dogs		Wildlife	
Picked Up	66	Handled	0
Claimed By Owner	10	Euthanized	0
Adopted	1		
Died in Kennel	0	Livestock	
Euthanized	38	Returned to Owner	0
Transferred to SPCA	17	Died in Kennel	0
Dead on Arrival	0		
		Other Companion Animals	
Fees Collected	\$415.00	Returned to Owner	0
Cats		Number of Calls to Shelter	116
Picked Up	13	Summons Issued	2
Claimed By Owner	0	Warrants Served	0
Adopted	0	Days in Court	1
Euthanized	13	Nuisance Dogs	25
Died in Kennel	0	Dangerous Dogs	0
Transferred to SPCA	0		
Dead on Arrival	0		
Fees Collected	\$0.00	Total Fees Collected	\$415.00

Bill the Town of Farmville

0 Cats housed (7 days each)

Total \$0.00

S. Ray Foster & Holly Morris, Animal Control

Building Official

Permits Issued Report
3/01/2011 Through 3/31/2011

BI411

ADDITIONS	- Issued	4
	- Value	\$52,750.00
	- Permit Fees	\$375.00
	- 2.00% STATE TAX	\$7.50
	- Fees Collected	\$.00
ONE & TWO FAMILY DWELLING	- Issued	3
	- Value	\$381,000.00
	- Permit Fees	\$1,162.40
	- 2.00% STATE TAX	\$23.24
	- Fees Collected	\$.00
ELECTRICAL	- Issued	9
	- Value	\$423,127.00
	- Permit Fees	\$485.00
	- 2.00% STATE TAX	\$9.70
	- Fees Collected	\$.00
FARM BUILDINGS	- Issued	1
	- Value	\$1,050.00
	- Permit Fees	\$.00
	- 2.00% STATE TAX	\$.00
	- Fees Collected	\$.00
MECHANICAL	- Issued	5
	- Value	\$402,900.00
	- Permit Fees	\$250.00
	- 2.00% STATE TAX	\$5.00
	- Fees Collected	\$.00
PLUMBING	- Issued	4
	- Value	\$396,000.00
	- Permit Fees	\$200.00
	- 2.00% STATE TAX	\$4.00
	- Fees Collected	\$.00
REMODELING	- Issued	1
	- Value	\$4,897.00
	- Permit Fees	\$75.00
	- 2.00% STATE TAX	\$1.50
	- Fees Collected	\$.00
Total Permits - Issued		27
Total Permits - Value		\$1,661,724.00
Total Permits - Permit Fees		\$2,547.40
Total Permits - StateTax 2%		50.94
		<hr/>
		\$2598.34

PRINCE EDWARD COUNTY CANNERY

7916 Abilene Road
Farmville, Virginia 23901

LENA HUDDLESTON
Cannery Manager
434-223-8664
Home 392-4218

March 2010 Cannery Report

During the month of March, the following number of cans and meat were processed:

48 (qt.)	@	.48	= \$	23.04
100 (gal.) –old-	@	.50	=	50.00
4 patron usage	@	1.00	=	4.00
Out-of-county 30% charge			=	<u>7.69</u>
TOTAL			\$	84.73

I sold 100 gallon cans that had been given to the Cannery for “dry packing”.

- **Lena Huddleston**

Prince Edward County Public Schools
35 Eagle Drive
Farmville, Virginia 23901

**Comparative Receipts and Expenditures
Year to Date**

Month of March 2011

Receipts:	Fiscal 2010			Fiscal 2011			Diff.
	Budgeted	Rec. YTD	Percent	Budgeted	Rec. YTD	Percent	
Sales Tax	2,687,309	1,912,707	71.18	2,559,727	1,985,562	77.57	6.39
Basic Aid	7,886,187	5,688,936	72.14	7,291,446	5,469,237	75.01	2.87
Other State	6,801,017	4,443,293	65.33	5,598,256	3,521,141	62.90	-2.44
Total State	17,374,513	12,044,936	69.33	15,449,429	10,975,939	71.04	1.72
Federal Funds	2,887,857	1,579,281	54.69	3,469,805	1,518,767	43.77	-10.92
Local Funds	7,968,567	4,202,090	52.73	7,913,044	4,142,143	52.35	-0.39
Cash Book	376,000	291,259	77.46	455,290	329,767	72.43	-5.03
Total Revenue	\$28,606,937	\$18,117,566	63.33	\$27,287,568	\$16,966,617	62.18	-1.16
Expenditures:	Budgeted	Expended YTD	Percent	Budgeted	Expended YTI	Percent	Diff.
Instruction	22,198,326	13,198,519	59.46	21,075,222	12,603,884	59.80	0.35
Administration	1,513,615	994,014	65.67	1,539,615	962,776	62.53	-3.14
Transportation	1,928,199	1,141,651	59.21	1,793,634	1,092,251	60.90	1.69
Maintenance	1,968,450	1,273,569	64.70	1,930,175	1,305,536	67.64	2.94
Food Service	10,580	7,901	74.68	11,436	8,409	73.53	-1.15
Facilities	137,725	68,512	49.75	142,967	91,470	63.98	14.23
Debt Service	850,042	844,929	99.40	794,519	791,207	99.58	0.18
Contingency Reserves	0	0	0.00	0	0	0.00	0.00
Total Expenditures	\$28,606,937	\$17,529,095	61.28	\$27,287,568	\$16,855,532	61.77	0.49

**Prince Edward County Public Schools
Summary Financial Report
Fund I**

(rounded to nearest dollar)

Month Ending March 31, 2011

<u>Revenues</u>	<u>Current Month</u>	<u>Year to Date</u>	<u>Budget</u>	<u>Actual Under (Over)</u>	<u>YTD as a Percent of Budget</u>
From the Commonwealth:					
State Sales Tax.....	\$ 185,198	\$ 1,985,562	\$ 2,559,727	\$ 574,165	77.57
Basic School Aid.....	\$ 835,776	\$ 5,469,237	\$ 7,291,446	\$ 1,822,209	75.01
All Other.....	\$ 594,859	\$ 3,521,141	\$ 5,598,256	\$ 2,077,115	62.90
Total State.....	\$ 1,615,833	\$ 10,975,939	\$ 15,449,429	\$ 4,473,490	71.04
From the Federal Govt.....	\$ 431,061	\$ 1,518,767	\$ 3,469,805	\$ 1,951,038	43.77
Tran. From General Fund (County)	\$ -	\$ 4,142,143	\$ 7,913,044	\$ 3,770,901	52.35
Cash Book -Local.....	\$ 155,535	\$ 329,767	\$ 455,290	\$ 125,523	72.43
Total Revenues.....	\$ 2,202,429	\$ 16,966,617	\$ 27,287,568	\$ 10,320,951	62.18

<u>Expenditures</u>	<u>Current Month</u>	<u>Year to Date</u>	<u>Outstanding Encumbrances</u>	<u>Budget</u>	<u>Expended & Encumbered (Over) Under</u>	<u>Expen. & Encumbrance as a % of Budget</u>
1000-Instruction.....	\$ 1,619,815	\$ 12,603,884	\$ 5,402,808	\$ 21,075,222	\$3,068,530	85.44
2000-Admin., Health/Att.....	\$ 105,109	\$ 962,776	\$ 310,089	\$ 1,539,615	\$266,750	82.67
3000-Transportation.....	\$ 178,401	\$ 1,092,251	\$ 321,977	\$ 1,793,634	\$379,406	78.85
4000-Operation/Maintenance	\$ 177,867	\$ 1,305,536	\$ 256,068	\$ 1,930,175	\$368,572	80.90
5000-Food Service.....	\$ 953	\$ 8,409	\$ -	\$ 11,436	\$3,027	73.53
6000-Facilities.....	\$ 9,200	\$ 91,470	\$ 40,095	\$ 142,967	\$11,402	92.02
7000-Debt. Ser.....	\$ -	\$ 791,207	\$ 2,887	\$ 794,519	\$425	99.95
8000-Contingency Reserve	\$ -	\$ -	\$ -	\$ -	\$0	0.00
Total Expenditures.....	\$ 2,091,345	\$ 16,855,532	\$ 6,333,925	\$ 27,287,568	\$4,098,111	84.98

Prince Edward County Public Schools
2010-2011
Comparative Receipts and Expenditures
Food Service Department
Year to Date
Month of March 2011

	Fiscal 2010			Fiscal 2011			
Receipts:	Budgeted	Rec. YTD	Percent	Budgeted	Rec. YTD	Percent	Diff.
State School Food	80,521	49,776	61.82	87,988	64,160	72.92	11.10
School Breakfast	2,124	0	0.00	0	0	0.00	0.00
	<hr/>			<hr/>			
Total State	82,645	49,776	60.23	87,988	64,160	72.92	12.69
Federal Reimbursement	750,000	483,821	64.51	750,000	531,342	70.85	6.34
Cash Book - Local	259,611	183,206	70.57	261,171	191,555	73.34	2.78
	<hr/>			<hr/>			
Total Revenue	\$1,092,256	\$716,803	65.63	\$1,099,159	\$787,058	71.61	5.98
Expenditures:	Budgeted	Expended YTD	Percent	Budgeted	Expended YTD	Percent	Diff.
Salary	399,089	263,191	65.95	380,723	248,264	65.21	-0.74
Fringe Benefits	137,354	92,920	67.65	138,362	89,235	64.49	-3.16
Purchased Services	19,253	18,142	94.23	53,775	12,927	24.04	-70.19
Telephone Services	0	0	0.00	1,544	920		
Travel	0	0	0.00	500	489		
Materials & Supplies	91,805	33,548	36.54	66,566	18,772	28.20	-8.34
Food Supplies	436,756	257,488	58.95	440,194	313,395	71.19	12.24
Repairs & Maintenance	0	0	0.00	8,000	3,491	0.00	0.00
Furniture/Equipment	8,000	461	5.76	9,495	3,463	36.47	30.72
Contingency Reserves	<hr/>			<hr/>			
Total Expenditures	\$1,092,256	\$665,749	60.95	\$1,099,159	\$690,955	62.86	1.91

Saved as March 10-11 Expense Compare Food Service

**Prince Edward County Public Schools
Food Service Department
Summary Financial Report
2010-2011
March 31, 2011**

Fund 4				Variance		
(rounded to nearest dollar)						
Revenues	Current Month	Year to Date	Budget	Actual Under (Over) Budget	YTD as a Percent of Budget	
From the Commonwealth:						
State School Food	\$ 14,137	\$ 64,160	\$ 87,988	\$ 23,828	72.92	
School Breakfast	\$ -	\$ -	\$ -	\$ -	0.00	
Total State.....	\$ 14,137	\$ 64,160	\$ 87,988	\$ 23,828	72.92	
Federal Reimbursement	\$ 84,724	\$531,342	\$ 750,000	\$ 218,658	70.85	
Cash Book -Local.....	\$ 25,010	\$191,555	\$ 261,171	\$ 69,616	73.34	
Total Revenues.....	\$123,871	\$787,058	\$1,099,159	\$ 312,102	71.61	

Expenditures	Current Month	Year to Date	Outstanding Encumbrances	Budget	Expended & Encumbered (Over) Under Budget	Expen. & Encumbrance as a % of Budget
Salary	\$ 29,994	\$248,264	\$ 110,094	\$ 380,723	\$ 22,365	94.13
Fringe Benefits	\$ 10,908	\$ 89,235	\$ 41,747	\$ 138,362	\$ 7,380	94.67
Purchased Services	\$ 1,494	\$ 12,927	\$ 838	\$ 53,775	\$ 40,010	25.60
Telephone Services	\$ 150	\$ 920	\$ -	\$ 1,544	\$ 624	59.57
Travel	\$ 444	\$ 489	\$ -	\$ 500	\$ 11	97.76
Materials & Supplies	\$ 1,056	\$ 18,772	\$ 2,512	\$ 66,566	\$ 45,283	31.97
Food Supplies	\$ 52,158	\$313,395	\$ 53,416	\$ 440,194	\$ 73,382	83.33
Repair & Maintenance	\$ 97	\$ 3,491	\$ -	\$ 8,000	\$ 4,509	0
Furniture/Equipment	\$ -	\$ 3,463	\$ -	\$ 9,495	\$ 6,032	36.47
		\$ -	\$ -	\$ -	\$ -	-
Total Expenditures.....	\$ 96,300	\$690,955	\$ 208,607	\$1,099,159	\$199,597	81.84

Saved as March 10-11 summary financial food service

**PERT RIDERSHIP
MONTH OF March 2011**

WEEK	DATE	PASSENGER COUNT	BUS LINE
Tuesday	1	25	
Wednesday	2	11	ORANGE
Thursday	3	15	ORANGE
Friday	4	16	GREEN
Monday	7	13	ORANGE
Tuesday	8	21	GREEN
Wednesday	9	12	ORANGE
Thursday	10	9	ORANGE
Friday	11	16	GREEN
Monday	14	9	ORANGE
Tuesday	15	19	GREEN
Wednesday	16	7	ORANGE
Thursday	17	11	ORANGE
Friday	18	21	GREEN
Monday	21	7	ORANGE
Tuesday	22	15	GREEN
Wednesday	23	6	ORANGE
Thursday	24	4	ORANGE
Friday	25	25	GREEN
Monday	28	13	ORANGE
Tuesday	29	18	GREEN
Wednesday	30	9	ORANGE
Thursday	31	5	ORANGE
			GREEN
TOTAL		307	

<u>BUS LINE</u>	<u>ROUTE</u>	<u>DAYS OF OPERATION</u>
GREEN	Prospect / Pamplin	Mondays & Thursdays
ORANGE	Meherrin / Green Bay	Tuesdays, Wednesdays, & Fridays

Tourism & Visitor Center Monthly Report for March 2011

VIRGINIA'S HEARTLAND REGIONAL VISITOR CENTER GUESTBOOK SIGNINGS:					
	Virginia Guests	Other States	Other Countries	Total Guests	Average Visitors per Month:
YTD 2011	212	103	11	326	108.7
2010	1126	636	68	1830	152.5

Total / 3 Months
Total / 2010

Requests for Information:

	Phone Inquiries	Mail Requests	Emailed Requests	Center Visits	Internet Sales	Monthly Totals:
March 2011	6	<u>832</u>	18	154	0	1,010
March 2010	6	586	15	141	0	748
% Difference	0.00%	41.98%	20.00%	<u>9.22%</u>		35.03%

	Total YTD Inquiries:
TOTAL YTD	2,481
2011 YTD	2,081
2010 YTD	1,233
% Difference	-46.15%
	131.48%
	25.86%
	25.87%
	-75.00%
	101.22%

Report to April Board of Supervisors:

- Despite the inconsistent weather, Visitor Center visits are up 9% over this time last year.
- Requests for fulfillment bags are on the rise: 6 phone inquiries translated to 128 fulfillment bags
 - 6 information bags are on their way to Greece!
- The new Virginia's Retreat website will roll out in April: more extensive site than anticipated.
- Best Part of the Civil War & Virginia's Retreat ads came out in Preservation Magazine, Civil War Times Magazine and Disney's Family Fun Magazine in March.

Websites monitored:

- Prince Edward County Tourism:**
2,132 hits in February
- Best Part of the Civil War:**
76 hits in February
- Virginia's Retreat:**
New website rolling out Apr 2011



VISITOR CENTER VOLUNTEER OPPORTUNITY

- **Calling all Volunteers! Working at the Heartland Regional Visitor Center is fun, educational, and you get to meet folks from all over the country – indeed, all over the world!**
- **We met a man from China the other day who was bicycling around the world – it was an amazing visit!**
- **Wouldn't you like to join us?**

THE HEARTLAND REGIONAL VISITOR CENTER is hosting a Volunteer Training Session!

THE HOURS ARE FLEXIBLE AND THE JOB IS FUN!

When: THURSDAY, April 21st, at 10 A.M.
(3rd Thursday each month)

**Where: THE HEARTLAND REGIONAL VISITOR CENTER
121 EAST THIRD STREET IN FARMVILLE**
(THE OLD DR. MOORE BUILDING - ACROSS FROM MACADO'S RESTAURANT)

A 2-HOUR TRAINING PROGRAM WILL BE OFFERED TO INDIVIDUALS WHO ARE INTERESTED IN VOLUNTEERING TO GREET VISITORS AND TALK ABOUT OUR REGION.

CALL 434.392.1482 FOR MORE INFORMATION, AND TO RSVP – TRAINING WILL BE LIMITED TO TEN PEOPLE.

FIRST MANASSAS MAP MASTERPIECE

CIVIL WAR TIMES

ESTABLISHED 1962

DEFIANT SOUTHERN WOMEN

**How They
Drove Old
Dixie Down**

Confederate women like Anne Gordon used guile or even guns to influence government policy.

Fort Sumter's
LAST HOURS

Does
MEADE
deserve
more
credit?

BEST AND WORST
Gettysburg
monuments

HistoryNet.com



\$5.99 US/Can

June 2011



THE BEST PART OF THE CIVIL WAR... THE END
Travel the path of Grant & Lee to Historic Appomattox, where along the way, some of the best shopping, antiques, dining, lodging and outdoor recreation is waiting for you.

Virginia is for Lovers ♥

BestPartoftheCivilWar.org



200 YEARS OLD & STILL BRAND NEW!
Known for its hospitality and history—the City of Fairfax enjoys a family and local community feel with great shopping, dining, arts, parks, trails and year round festivals. Now recently recognized by Forbes by being #3 Best Places to Live Well in America!

703-273-6097

VisitFairfax.com



FRONT ROYAL, VIRGINIA
Steeped in rich history and natural beauty this thriving community boasts attractions and amenities for everyone – all within a stone's throw of the Nation's Capital. Attractions include Shenandoah National Park, Skyline Drive, The Shenandoah River, Skyline Caverns and Historic Downtown.

800-338-2576

Discoverfrontroyal.com



WESTERN VIRGINIA RETIREMENT GUIDE
New information on retirement living in the beautiful Blue Ridge Mountains of Virginia... Roanoke, Smith Mountain Lake, Blacksburg, Lynchburg and more. Call For Your Free Copy Today!

800-548-1672 ext. 4026
Retire-VA.com



SHENANDOAH VALLEY
Visit the legendary Shenandoah Valley of Virginia and West Virginia celebrated in song and folklore. Breathtaking mountain views and charming small towns live two hundred miles of welcoming countryside.

800-847-4878 or 540-740-3132

VisitShenandoah.org



VIRGINIA'S RETREAT
Southern Virginia's Premier Destination for Civil War History, Civil Rights History and Outdoor Recreation



Virginia is for Lovers ♥

800-6RETREAT

VARetreat.com



PETERSBURG-AREA REGIONAL TOURISM

The last year of the Civil War saw Lee and Grant locked in a 9 1/2 month life-or-death struggle in the Petersburg Region. Experience the Siege of Petersburg and plan your trip at PetersburgArea.org or OnToRichmond.com.

804-861-1000

PetersburgArea.org



CAN YOU NAME THIS U.S. CITY?

It may be America's best kept secret.
• Top-10 place to raise a family
• Rated #6 for health care.
Call for your 100+ page guidebook. You'll have all the answers on Roanoke, Virginia.

800-548-1672

TheRoanoker.com



It's at the heart of every Virginia vacation.

Virginia ♥
is for Lovers

Virginia.org



Make Room for the Memories.

An adventure of historic proportion is waiting for you—at two living-history museums that explore America's beginnings. Board replicas of colonial ships. Grind corn in a Powhatan Indian village. Try on English armor inside a palisaded fort. Then, join Continental Army soldiers at their encampment for a firsthand look at the Revolution's end. Don't forget your camera. Because the history here is life size. And your memories will be even bigger!

JAMESTOWN & YORKTOWN
SETTLEMENT & VICTORY CENTER
1-888-803-4582 or www.historytstn.org

Save 20% on a combination ticket to both museums.

VIRGINIA'S BLUE RIDGE MOUNTAINS



Visit the Blue Ridge Mountains of Southwest Virginia and enjoy outdoor recreation, museums, live theatre, themed parks and zoos, wineries and much more! FREE GUIDES.

800-446-9670
virginia-blueridge.org

LEXINGTON, VA



In this place nature, family fun and history come together. By car, canoe or carriage... Rockbridge County stays with you long after you've passed through.

877-453-9822
lexingtonvirginia.com

BLUE RIDGE PARKWAY



Terrific guide to all the best attractions, crafts and lodging in and around the Smokies and along the Blue Ridge Parkway. Call for your free copy of this 100 page guide and make your planning easy.

800-548-1672
blueridgeparkwayusa.com

THE BEST PART OF THE CIVIL WAR...THE END



Travel the path of Lee & Grant to the Surrender Grounds at Appomattox, where along the way, some of the best shopping, antiques, dining, lodging and outdoor recreation is waiting for your family.



BestPartOfTheCivilWar.org

Virginia.org

It's at the heart of every Virginia vacation.

Virginia 
is for Lovers

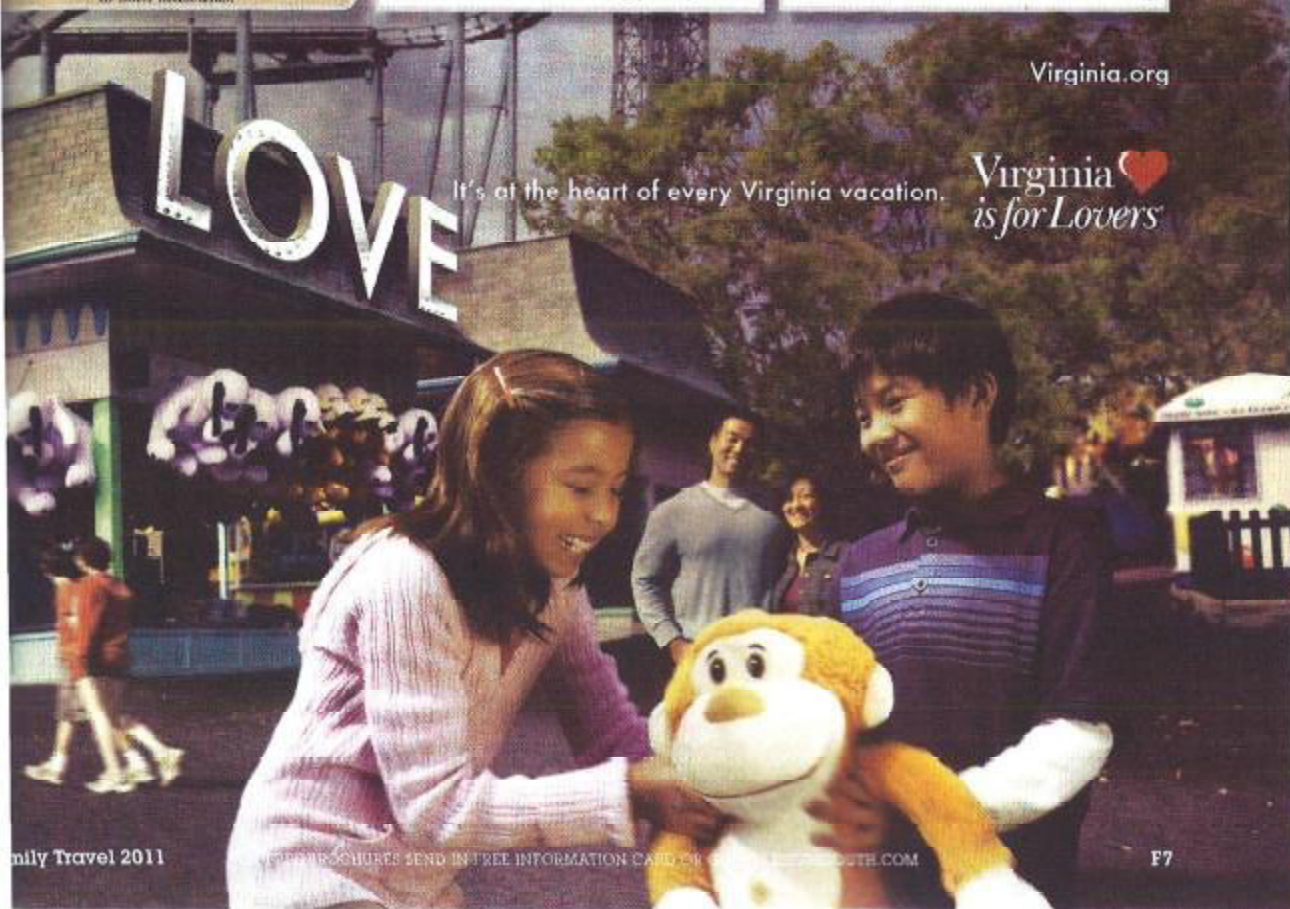

Family Travel 2011

FOR MORE SCHEDULES SEND IN FREE INFORMATION CARD OR VISIT WWW.VIRGINIA.ORG

F7